

Designed by GamFratesi

**PRODUCT**



Item no  
 Table top: 10022FH-Ø105  
 Frame: 10022ST-Ø105  
 + style code

**DESCRIPTION**

TS Table is designed by GamFratesi. TS table work together as a small group, complementing each other with its different sizes and heights, but they also work equally well as singles. TS Table is available in four sizes, with a marble/glass table top, black lacquered/brass frame.

**VERSION**

Bianco Carrara - white marbel top // black lacquered frame / RAL 9005 gloss 15  
 Nero Marquina - black marbel top // black lacquered frame / RAL 9005 gloss 15  
 Verde Guatemala - green marbel top // black lacquered frame / RAL 9005 gloss 15

**TYPES**

Order item - look for part number in the pricelist.  
 The series consists of the following:

**TS TABLE Ø40, TS TABLE Ø55, TS TABLE Ø80, TS TABLE Ø105, TS TABLE ROUND CONSOLE Ø40, TS TABLE 2 CONSOLE, TS TABLE 1 CONSOLE.**



**MEASUREMENTS**

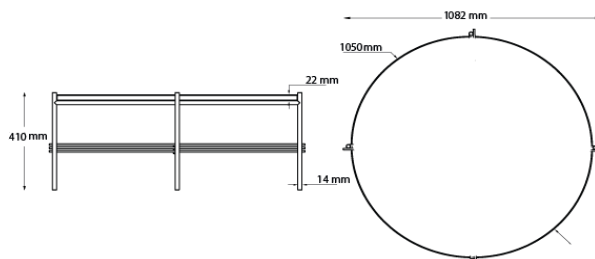

**COLOURS**



Notice: The TS lounge table X-large is not available in brass frame

**FACTS**

**MEASUREMENT**  
 Height: 410 mm  
 Width: 1082 mm  
 Table top diameter: 1050 mm  
 Table top thickness: 20 mm  
 Leg diameter: 14 mm

**WEIGHT ITEM**  
 Ø105: Table top 51,3 kg, Frame 5,5 kg

**PACKAGING TYPE**  
 Cardboard box, Chipboard, Foam

**PACKAGING MEASUREMENT Ø105- L X W X H CM**  
 Table top: L: 115 X W: 115 X H: 6,5 CM  
 Frame: L: 82 X W: 82 X H: 44 CM

**WEIGHT PACKAGING - MATERIAL TYPE**  
 Ø105 Table top:  
 - Delivery note: 5 g  
 - Chipboard: 24700 g  
 - Foam protector: 30 g  
 - Strapping: 10 g  
 Total: 24,745 kg

Ø105 Table frame:  
 - Delivery note: 5 g  
 - Cardboard: 1400 g  
 - Foam protector: 50 g  
 Total: 1,455 kg

**WEIGHT TOTAL:**  
 83 kg

**NUMBER OF PARCELS**  
 2 psc.

## CLEANING AND MAINTENANCE

---

### **Black Lacquered Metal Frame**

Daily cleaning is done by wiping the frame with a clean dry cloth, or with a cloth hardly wrung in clean water. Dirty surfaces are cleaned with a hardly wrung cloth out of soapy water or in water with added liquid soap. Wipe after with a clean dry cloth.

### **Marble Top**

In order to protect the marble top against penetration of grease and alike, it is advisable to saturate the surface of the marble. We recommend using water with soap flakes or coconut soap. Rinse with semi hot water. Bees wax or a wax based on coconut oil may also be used. Apply the wax with a dry, undyed cloth. When the wax has dried completely in to the marble, polish the marble with a dry undyed cloth.

During the first 14 days of usage, we recommend that this is done 3-4 times. After that, when needed.

Please note that marble may change the expression and color depending on the treatment.

Normal cleaning is done by wiping with a cloth wrung out in hot water with liquid detergent or soapy water.

Marble is a limestone and does therefore not tolerate unfettered acid, such as vinegar, lemon juice, stains of vine, as well as aggressive and acidic cleaning products. Such stains may be impossible to remove. In case of spilling something acidic on the marble top, immediately wash away!

Do not use scouring pads or abrasive cleaners as this may damage the surface.

#### **Heat Stress:**

Marble can withstand heat in a short period of time, but does not tolerate extremely high temperatures. Glowing hot cookware directly from the stove can pull out the fat from the marble, and this will show as a spot or you risk that the top cracks.

Therefore always use a trivet.

Do never pull any sharp or rough objects across the plat.

## ENVIRONMENT

---

Parts can be separated and sorted for recycling.

## TESTS

---

-

## CERTIFICATION AND LABELS

---

-