

pode



# AT HOME WITH PODE

COLLECTION 2019











# CONTENTS

---

## Pode

- 4 Make yourself at home
- 6 The great thing about facts
- 8 When you get to know Pode,  
you get to know us
- 12 Passionate craftsmanship
- 79 A photographer without a camera
- 94 The light on you

## Other

- 116 Fabrics and materials
- 124 Sizes
- 136 Service and guarantee

## Designers

- 8 Claire en Roderick Vos
- 25 Pascal Bosetti
- 29 Formstelle
- 34 Thijs Smeets
- 40 Jet Dircks
- 61 Ontwerpduo
- 73 Kranen/Gille
- 98 Michael Raasch

---

## Collection

- |     |               |            |
|-----|---------------|------------|
| 100 | Abstract      |            |
| 85  | Batch         |            |
| 87  | Bayan         | 52 Nihan   |
| 72  | Bottle Stool  | 96 Pom     |
| 80  | Boya          | 108 Puff   |
| 103 | Cadre         | 104 Punto  |
| 76  | Chiba         | 96 Pylaz   |
| 69  | Crude         | 110 Romboo |
| 60  | Cubb          | 106 Rye    |
| 104 | Dew           | 43 Skitch  |
| 108 | Dot           | 36 Sparkle |
| 108 | Dusk & Dawn   | 35 Spot    |
| 41  | Edit          | 113 Swell  |
| 30  | Fold          | 57 Swipe   |
| 68  | Fynch         | 108 Tab    |
| 92  | Golden Nugget | 28 Tibia   |
| 107 | Haze          | 82 Tokai   |
| 97  | Hood          | 56 Transit |
| 77  | Hux           | 90 Tripod  |
| 42  | Insert        | 66 Tubble  |
| 102 | Mackay        | 97 Uturn   |
| 44  | Melloo        | 18 Ziggy   |





# MAKE YOURSELF AT HOME

---

A sofa is a sofa, and a chair is a chair. Interiors used to be that simple. But that's certainly no longer the case. The way in which we use our interior is changing continuously. And at Pode, we think that's wonderful, because it means we are continuously challenged to fulfil your living requirements in the best and most beautiful way possible.

## Trends from everywhere

Looking at furniture and interior trends and developments, it's not only the shapes, fabrics and colours that change; the general function of furniture changes too. For instance, a dining table is often used as a work station. And a new sofa needs to be suitable for binge-watching as well as offering your visitors a comfortable place to sit. We respond as far as possible to these types of developments.

## Vigilant about sustainability

Our products are also changing as a response to sustainability. You won't notice anything when you use the furniture, but we are all benefiting from this. This includes choosing responsible materials and optimising production processes to minimise residual waste and to reuse this where possible.

## The right choice

Yet, our most important goal is to develop new products that are exactly what you're looking for. This is also important to bear in mind when you're making your choice at your dealer. If you see something you like, make yourself at home and take a seat, or lie down and hang out like you'd do in your own living room. And take all the time you need. Because that's the only way you can really decide whether an item of furniture deserves a place in your interior. In the most familiar place on earth.

Sebastiaan Sanders  
Executive Director Pode



# THE GREAT THING ABOUT FACTS

---

In life, you make the most important choices with your heart. For example, when you fall in love with somebody or something, it just happens; it's not something you calculate in advance. At Pode we obviously hope that the choice you make with your heart leads to our collection. Fortunately, there are also plenty of rational reasons for choosing Pode.

## **Design that makes you smile**

For us, furniture is more than just a single design. We offer you a complete lifestyle collection of furniture and accessories designed by international top designers, all of whom complement each other perfectly in terms of visual language, colour and feeling.

## **Comfort and quality based on knowledge**

You can enjoy Pode furniture for years. That's because all our products are based on Leolux's craftsmanship and years of experience. Our 'mother ship' has been making high-quality design furniture for almost 85 years and that expertise shines through in every Pode product. And high-quality products should always be

accompanied by professional and personal advice. Which is why we're so proud of the many expert dealers around the world who are ready to help you.

## **Affordable with an excellent guarantee**

As you can imagine, we want to make the Pode lifestyle accessible to as many people as possible. That's why we're raising the bar to the highest level when it comes to the quality and appearance of our products. But not when it comes to the price. What's more, we also give you a 2 year guarantee for extra assurance.

## **A mix of the loveliest materials**

The quality of our products is also down to the suppliers that we work with, of course. Which is why we purchase not only our materials and leather, but also our foam, wood, metal and every other material that we use, from reputable suppliers.

And that's the great thing about facts: you can use them to validate what you had decided to do anyway.





CLAIRE & RODERICK VOS

# WHEN YOU GET TO KNOW PODE, YOU GET TO KNOW US

---

If the Pode style appeals to you, that's largely down to the vision of two people: Roderick and Claire Vos. Since 2016, as art directors they have been responsible for the image and collection of Pode. For Claire and Roderick, design is much more than work. It's who they are. And to find out more about them, we got them to tell us their story. About each other, and obviously about Pode.

## Roderick about Claire

"Claire and I complement each other in exactly the right places. When it comes to the two-dimensional side of design, she is totally brilliant. She has an absurdly good memory for colours and images. If I say today 'that's a nice colour', a few days later she will effortlessly pick it out from the swatch block. Because we've had so many adventures together over the past thirty years, we're like two sides of a brain. For example, Claire is very structured and organised; I'm much more chaotic. She's also more diplomatic than I am. For example, when it comes to what we ask of other people. You can always demand the maximum from yourself, but it's not realistic to constantly do that to other people. Claire is often more aware of that than I am. And if I'm busy designing something, she's the only person who can 'interrupt' and even throw away sketches. We give each other energy, but we also pull each other up at the right moments. Working together creates that extra spark which makes it really good."





# 'WE COMPLEMENT EACH OTHER IN EXACTLY THE RIGHT PLACES'

RODERICK VOS







### **Claire about Roderick**

"Roderick's strength as a designer starts with his knowledge of production and technology. He can also get hugely enthusiastic about products and details and that's very infectious. But he always needs to set the bar a bit higher. Overcome new barriers again and again. The feeling that he is continuously developing as a designer is very important to him. So you'll always hear him say: 'This is the best thing I've made up to now'. In my own work, Roderick is my sounding board. I know exactly what I want, but I'm always glad if he thinks the same. And it works the other way too. I'm not a three-dimensional designer, but I can see where something isn't quite right and I'll point it out. We're very good at checking with each other whether we're reaching the level we aspire to. In our work at Pode, but also at home. Our home is very eclectic, we choose the best. But we never argue about what we put in it. We live together in that world."

### **Roderick and Claire about Pode**

"For us, it's a dream to be able to put our heart and soul into Pode. We deliver a collection of seating furniture which you can enjoy for a long time, as well as a range of beautiful accessories so that you can update your interior and add accents. We're also involved in all the ways in which people come into contact with the brand, from scouting designers to talking about the photography, which is amazing to do. Because we're able to put so much passion and love into this brand, it's very close to our heart. When you get to know Pode, to some extent you get to know us."





A workshop scene featuring a light-colored wooden cabinet in the background. In the foreground, a green upholstered chair is partially visible. To the left, a wooden structure resembling a funnel or a piece of furniture is mounted on the wall. A blue coiled cable hangs from the top left. A vertical red and blue cable runs down the right side of the frame. The overall atmosphere is one of a creative and industrial workspace.

# PASSIONATE CRAFTSMANSHIP

## FROM SKETCH TO FURNITURE

Anyone who thinks that Pode furniture comes from a factory is absolutely right. But anyone who thinks that it comes from an assembly line is mistaken.

Pode furniture is made by real craftspeople. The process starts by creating a prototype at our development department in Venlo. That's where the idea really comes to life and where the designer's 2-dimensional sketches are made into real 3-dimensional objects. And then it's all about practical details, about the finer aspects that make the end product better. An extra angle in the cushion foam can make a sofa

more comfortable. And a slightly wider wood joint can double the life span, while a double seam can improve both the quality and the design. But sometimes it's more about leaving things out rather than putting things in. That too can make an item of furniture more attractive and more effective.

It is only when the designer and the product developer are in agreement that a Pode item of furniture will go into production. In our ultra-modern factories in Hungary and the Netherlands, where high-tech and traditional crafts go hand in hand.





## The woodworker

Richárd creates the wooden frame of your furniture. This is the indestructible basis of your new sofa or armchair.



## The upholstery cutter

We cut most of the upholstery materials digitally. That level of accuracy cannot be surpassed. But we still need somebody like Betsy, who knows exactly how to cut a patterned fabric. And she checks every piece of leather for any scars or irregularities.



## The comfort maker

The foam under the fabric creates the shape, the appearance and – last but not least – the sitting comfort. So we don't have to explain the importance of the job done by Krisztián, our cushion maker.

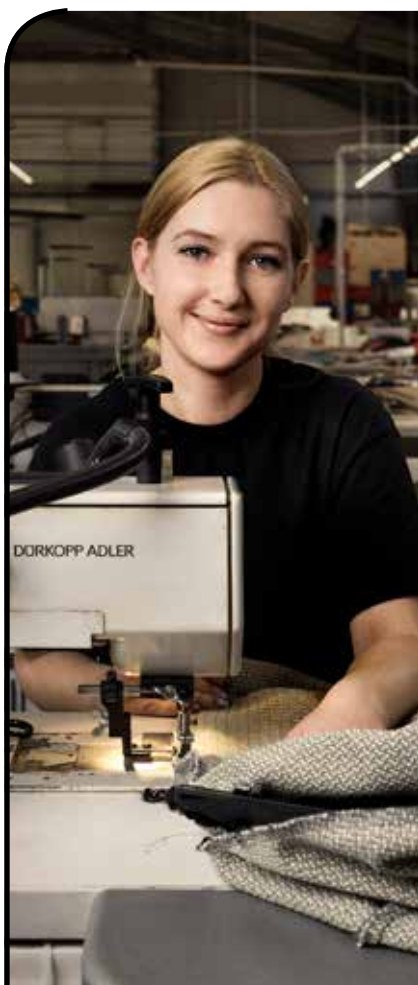

## The seamstress

Just like in times gone by, the stitching done by Gabriella is intended primarily for holding the upholstery of your furniture together. People are fortunately realising more and more that a decorative stitching adds value to the design of an item of furniture.



## The upholsterer

They are craftspeople through and through, the upholsterers. And you don't become an upholsterer without exceptional talent - just ask Csaba. This craft actually determines the end result. That's why the upholsterer is also the last person to check the final product.



## The lacquer specialist

Not forgetting: Wil, the lacquer specialist. He makes sure that wooden table tops, legs and armrests are sanded, lacquered and stained properly.

Together they manufacture a product that meets the highest quality standards. And that's good to know if you like PODE. Because you can see the result of their work straight away, but you only notice it after years of use.





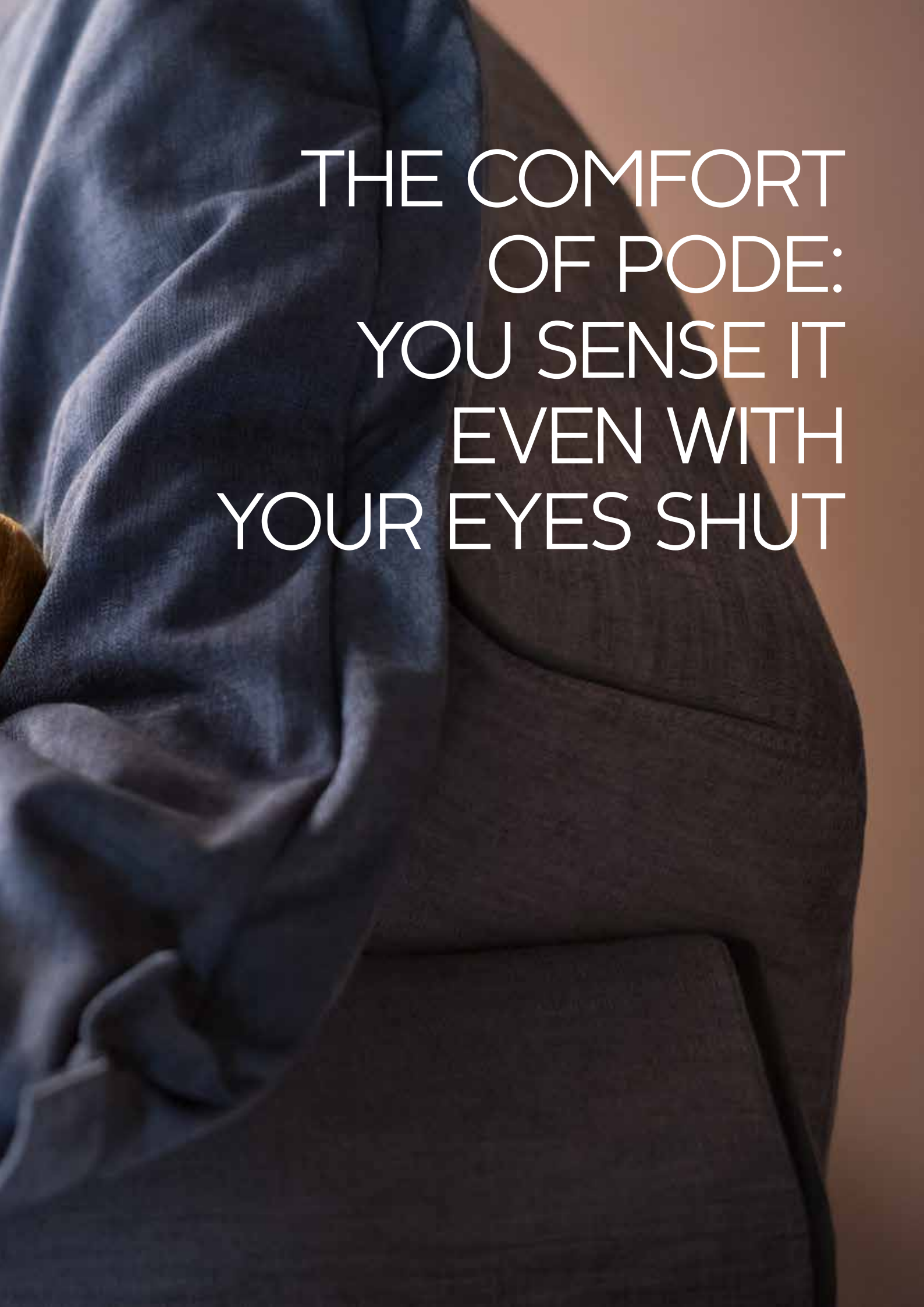

THE COMFORT  
OF PODE:  
YOU SENSE IT  
EVEN WITH  
YOUR EYES SHUT



# Sofa | Ziggy

Design: Pascal Bosetti, 2018.

---

Sitting in Ziggy is heavenly. This extensive modular sofa by Pascal Bosetti seating programme offers you every freedom. Whatever configuration you want for your sofa, you can create it with Ziggy. Straight sofas or corner elements or, with a bit of imagination, you can even compose the Z from Ziggy. All elements can also be used as stand-alone or connected items. Ziggy is available in all fabrics and you can also enjoy roomy loose upholstery and padding that moulds itself wonderfully to your body.

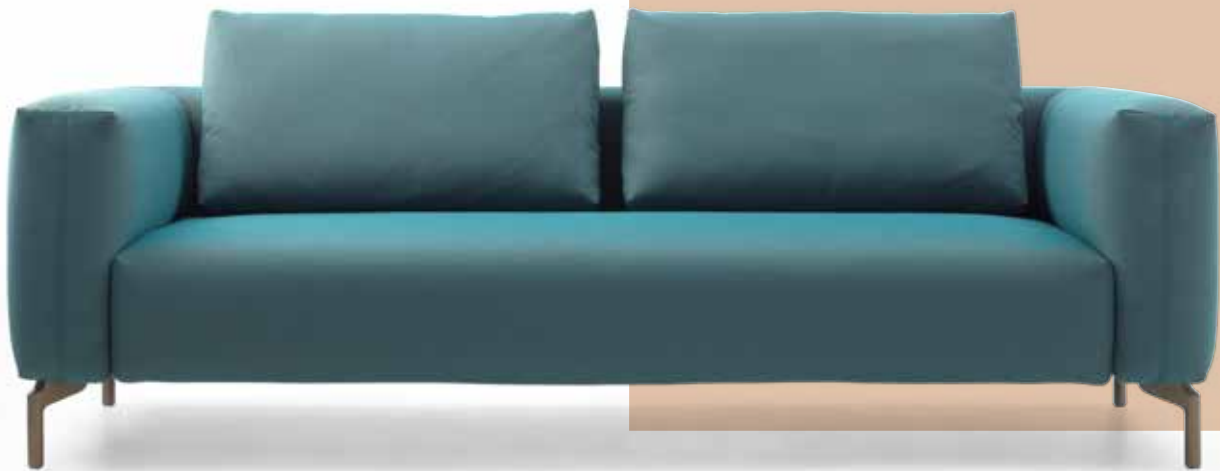

**Sofa** Ziggy Element sofa 240  
**Upholstery** Steelcut trio 3-996



Sofa Ziggy element 170 SBR Footstool Ziggy 106x106cm Rug Punto Lamp Pom

Sofa Ziggy element 220 SBL + element sofa 265 **Coffee table** Tubble **Rug** Rye **Lampe** Pylaz









# Sofa programme | Ziggy

## Programma

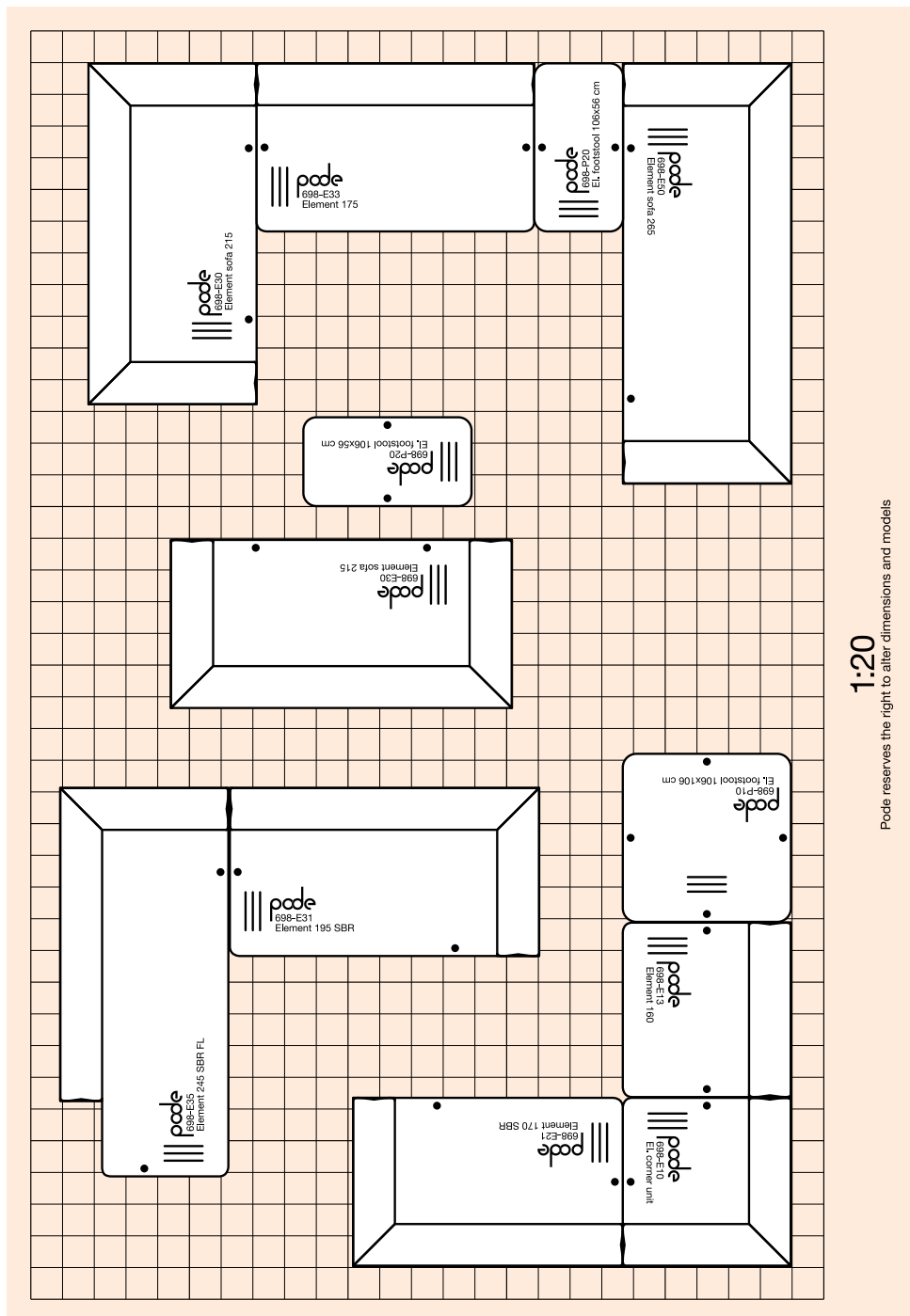

1:20

Pode reserves the right to alter dimensions and models

### Must-have accessories

The optional back cushions and special comfort cushions are available in both fabric and leather, creating that perfect finishing touch. Ziggy also has various handy accessories. For instance, there's a round or oval oak tray, ideal for your book, drink or remote control. And the foldable cushion, available in three sizes, is an absolute must-have! It helps you to shorten the seating depth when necessary or makes you feel extra relaxed in a more horizontal position.

Complete your own dream sofa, from A to Ziggy.



Sofa programme Ziggy element 220 SBL +  
element 220 SBL +

Upholstery Nomad Ruby

Sofa programme Ziggy element footstool 106x106cm

Upholstery Recheck 565





## PASCAL BOSETTI

---

Pascal Bosetti (1981) studied in Basel, works in Munich, teaches in Cologne and –on top of it all- speaks excellent Dutch. For several years he has been regularly designing products for the Pode collection. From the Ziggy sofa range and Nihan chair to the Tokai and Chiba dining chairs. We can undoubtedly speak of a very versatile designer.

"For me, Pode is a brand that stands for reliability, for

homely feeling. It's the house of a good friend that is decorated in such a way that you think: 'I would love to live here'. That is the warmth that I want to reflect in my designs. It is how Ziggy got its soft design and why Nihan's back and seat invite you to sit down, like open palms of your hands. The warmth is also reflected in the materials I choose. I like working with wood, as you can see in Nihan and Tokai. In every design I try to find a mix of styles and materials that makes an interior a home."





**Sofa** Ziggy element 220 KRL + element 220 KRR PL **Armchair** Tibia **Coffee table** Tubble **Rug** Punto **Lampe** Pylaz





# Chair | Tibia

Design: Formstelle, 2018.

Tibia is Formstelle's first design for Pode, with which this German design studio demonstrates immediately that it knows all about good design. Tibia has a shell seat that envelopes you comfortably. This wonderful seat can be upholstered in any fabric or leather from our collection, providing the perfect match for your interior.



Chair	Tibia
Upholstery	Lucir 600
Feet	Epoxy Taupe
Chair	Tibia
Upholstery	Fay Surf
Feet	Epoxy Lava





## Formstelle

---

Formstelle agency was established in 2001 by designer duo Claudia Kleine and Jörg Kürschner. As designers they are expert in three domains: interior design, corporate identity and product design. And in practice, of course, these disciplines regularly converge within one project, enabling the creation of innovative total solutions, varying from a few products to complete interiors and buildings.

### **Significant focus on research**

Whatever the project, Formstelle always places a significant focus on spatial and contextual relationships. The agency is known for its extremely high conceptual, technical and aesthetic quality standards. This applies to individual products as well as for interiors. Particularly the interaction and relationships between people and the spaces in which they stay are always subject to careful research.

### **The human scale**

The world today is so hectic and dynamic that we can see a growing need for peace and relaxation. That's why Formstelle have opted for a very clean design style. Forms need to be inviting and proportions need to be on a human scale. Thanks to its natural and easy-going look, the Tibia design suits a wide range of creative work settings and home environments.

Tibia was inspired by a piece of clothing. The turnover on the edge of the seating shell and the soft upholstery remind you of the details found in fashion items. The chair envelopes the user and its round contours allow you to sit in it in a variety of positions. The architectural metal frame, with striking leg ends, draws attention to the 'floating' seating disc. A wide choice of colours for the frame allows the client to develop any number of subtle combinations of materials.

# Sofa | Fold

Design: Roderick Vos, 2016.

---

Roderick Vos: "With this design, I was aiming to create a sturdy family sofa, a sofa for young and old. Design to be enjoyed. In every sense of the word. This innovative and timeless sofa was created by Folding the upholstery fabric and cutting it as little as possible. Hence its name: Fold. I have a preference for comfortable cushion sofas, but for this design I actually avoided the image of 'loose cushions', giving rise to a lovely abstract sofa with no excessive details."



Sofa Fold 3-seater  
Upholstery Fusion Chile

---

---







## THIJS SMEETS

---



Thijs Smeets studied Industrial Product Design at The Hague University of Applied Sciences. He has now been running his own company for 10 years: Studio Smeets Design, based in a wonderful art nouveau building in the centre of Amsterdam, with a view of the Westertoren. For Pode, he has designed the Swipe sofa and the Sparkle, a rotating armchair.

"Some time ago, I read a wise saying: 'Keep your heart where your feet are'. Nowadays it is quite difficult to keep your work and your private life separate. To not be constantly disturbed at home by texts, news, social

media, email, telephone and other distractions. Make your home a sanctuary, dedicated to the things that really matter. My home is a place where I can relax and where I want to be with the people who are most dear to me: my girlfriend and children. Love, warmth, connection and pleasure – I try to incorporate these things into my designs for Pode with simple linear patterns and with rounded, friendly shapes. A home without soft, comfortable furniture has no soul. Your interior reflects who you are, so make something of it. It helps you face the world with fresh courage every day."



Design: Thijs Smeets. 2019.

---

Spot gives you a wonderful family feeling, just like so many other Pode products. This is even more the case with this beautiful swivel chair, especially, because Spot is a full cousin of our Sparkle. Despite the clearly recognisable family lines drawn by Thijs Smeets, Spot is unique. The seat has fixed upholstery, for example, without a loose cushion, giving it a very different look.

## Armchair | Spot



- |            |   |
|------------|---|
| Armchair   | 1. Sparkle Two (high)                       |
|            | 2. Spot One (low)                           |
| Footstool  | 3. Spot                                     |
| Upholstery | 1. internal Feltwool 20<br>external Ruig 01 |
|            | 2. Nomad Indigo                             |
|            | 3. Feltwool 20                              |
| Base       | 1. Epoxy Nuit                               |
|            | 2. Epoxy Taupe                              |
|            | 3. Epoxy Nuit                               |

# Armchair | Sparkle

Design: Thijs Smeets. 2014.

A splendid swivel armchair with a strong retro look: Sparkle. By varying the colours of the body, the seat cushion, the swivel base and the decorative stitches, you can create audacious combinations. Colour-to-colour or vividly contrasting. The high Sparkle TWO version gives the design a sense of grandeur and offers even more comfort than the existing low version.



- Armchair
  - 1. Sparkle Two (high)
  - 2. Sparkle One (low)
- Upholstery
  - 1. internal Steelcut Trio 436 / external Neron Cinnamon
  - 2. internal Steelcut Trio 983 external Fusion Cucumber
- Base
  - 1. Husk Naturel
  - 2. Basiq Lac 271 Forest





**Sofa** Insert connection sofa AR + element 3-seater AL **Footstool** Insert (82x52 cm) **Table** Gloss (ø 80 cm) **Occasional table** Bottle Stool









## JET DIRCKS

---

Jet Dircks is the only designer who works at Pode on a permanent basis. However, she does much more than design. She selects other designers, gives briefings, maintains contacts, and gives feedback during the design process. It was she who designed the Edit and the Insert.

"The Edit is a very sober minimalistic which is comfortable and which is selling well. And if you need something bigger, you can expand it with the help of the Insert programme. That way, you get a lounge corner in one go.

I do enjoy designing, make no mistake, but detecting trends and steering young talent in that direction is really fascinating. I come from an entrepreneurial family, so the independence of this position really suits me. Where my most important inspiration comes from? Haha, from deep inside me, from my intuition. And it's usually correct."

Design: Jet Dircks, 2008.

---

Super in fabric, fantastic in leather! Or a combination of fabric with leather piping. The sleek Edit design sofa fits everywhere, even in the most functional interior. With a little bit of colour, Edit is suddenly transformed. Also available with matching ottoman.

## Sofa | Edit



**Sofa** Edit 3-seater  
**Upholstery** Tonica 2-933  
**Feet** Needle, Epoxy Nuit





Sofa  
programme |  
Insert

Sofa programme	Insert Element 3-Seater AL + Connection sofa FR
Upholstery	Tweed 319 Heron
Piping	Neron Sesame

Design: Jet Dircks/Roderick Vos, 2016.

---

Skitch by Pode; a 'composition' of pipes that can be combined to create a small table. This sophisticated design is available in three sizes that you can combine perfectly and use in many different ways. As a coffee table or as a side table. To create a varied landscape in your living room. In matching colours that you harmonise with your interior.

## Table | Skitch



Table Skitch  
Colour Table leaf Oak  
Frame Epoxy



Sofa Melloo 3-s. unit AL + Lounge el. AR Cushion Puff Rug Mackay Table Tripod Occasional table Golden Nugget





# Sofa | Melloo

Design: Roderick Vos, 2017.

---

The world of Melloo revolves around you. With many sofas, elements and a matching footstool, you can compile this friendly and inviting Roderick Vos design exactly as you want it. The modular sofa programme challenges you to give your creativity free rein. Melloo is unique thanks to the round corner unit that you can use to build your own comfortable Melloo landscape. And of course, you can also select right-angled corners. Add a lounge element so that you can relax at full stretch, or extra seating elements so that friends and family can enjoy the sofa with you. Melloo is the most complete range in our collection, with all the use options you need for your interior.



Sofa Melloo 3-seater  
Upholstery Maple 792

Cushion Puff  
Upholstery Maple 792



Sofa Melloo 3,5-seater Cushion Puff Rug Mackay Coffee table Tripod



Sofa Melloo 2-s. unit AR + Lounge el. ALL **Chair** Nihan **Occasional table** Tripod **Rug** Mackay **Dining room chair** Tokia **Table** Fynch







# Sofa programme | Melloo

## Programma

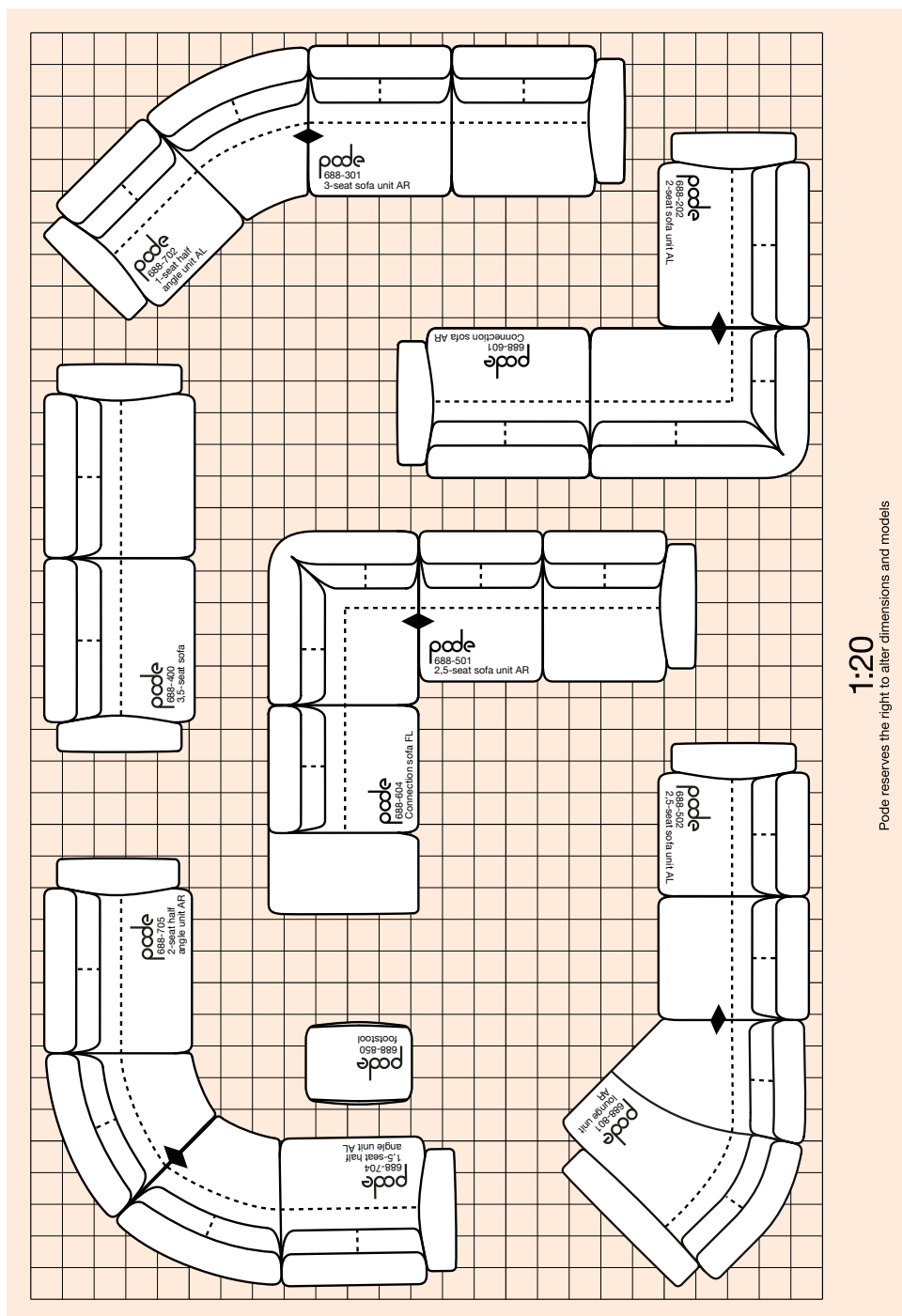

### The boldness of the details

One fascinating detail is the way the Melloo elements always connect to each other with one leg. That creates an impression of calmness rather than a forest of legs. And when you're happy with your configuration, you can choose the ideal upholstery from our collection. You can also add an extra personal detail by designing the flat piping along the edges in a different material: fabric, leather, vibrant or subtle. Or you can choose an extra Melloo-cushion – needless to say, in your favourite material. That way, you create a sofa that truly belongs to you: say hello to Melloo.

Design: Roderick Vos, 2017.

---

Unique of the Melloo modular system are the circular corner elements which enable you to create your own comfortable Melloo landscape. Add a lounge element, or additional seating elements to create more space for your guests. Melloo is the largest series in our collection which offers all imaginable configurations for your interior.



**Sofa** Melloo 2,5-s. unit AL  
+ connection Sofa AR

**Upholstery** Nomad Nougat









Design: Pascal Bosetti, 2017.

---

Nihan is wonderfully laid back: it's an armchair you can really relax in. And have you already discovered the inventive details? The stylish joint between the back and frame, which conceals all the fastening materials. And the frame itself; it's not as simple as it looks either, with its subtle curves that perfectly match the fluid shape of the seat and the back.

## Chair | Nihan



Chair Nihan  
Upholstery Ruvido Amparo  
Oak Naturel  
Support Epoxy Nuit

# Armchair | Transit

Design: Roderick Vos. 2016.

Sometimes, sitting down feels almost too good. In the Transit armchair, designer Roderick Vos subtly combines shape and comfort. With sleek lines, a floating seat and legs made of curved pipe material, but above all casual, loose upholstery. Transit is available with a high or low back, a choice that influences both the appearance and the degree of comfort. Whatever suits you best. And do you know what also looks fantastic? Two armchairs beside each other. The perfect picture!



- Armchair
  - 1. Transit One (low)
  - 2. Transit Two (high)
- Upholstery
  - 1. Neron Cinnamon
  - 2. Steel Cut trio 416
- Feet
  - 1. Epoxy Khaki
  - 2. Epoxy Nuit

Design: Thijs Smeets, 2015.

---

Swipe is Dutch pragmatism with international appeal. You feel it when you sit down, and you see it in the elegant lines, the rich decorative stitch and the balanced proportions. Swipe is simply lots of sofa for your money. The matching ottoman gives an extra dimension to the sofa it accompanies.

## Sofa | Swipe



**Sofa** Swipe 3.5-places  
**Upholstery** Divina MD 613  
**Feet** Lac Powder  
not available in all international markets





**Sofa** Swipe 3-seater **Footstool** Swipe **Armchair** Transit Two **Table** Gloss (ø 80 cm)



# Sofa | Cubb

Design: Ontwerpduo, 2016.

A good design can look really natural. Ontwerpduo's Cubb sofa is a design sofa with lovely details and a clearly-defined shape. Sleek, straight lines for the seat and the back; underneath, a lovely oak base with projecting feet. But Cubb is not only great to look at – when you sit on it you also realise how comfortable it is. That's craftsmanship from Pode.

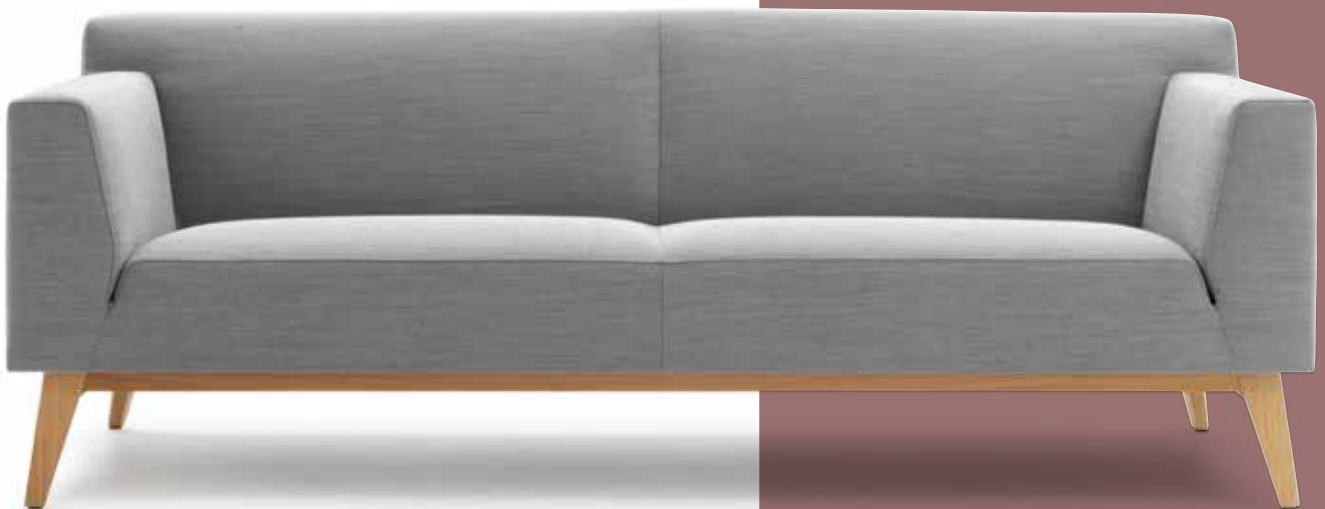

**Sofa** Cubb 3-seater  
**Upholstery** Steelcut Trio 124  
**Frame** Oak Naturel

not available in all international markets

## ONTWERPDUO

---

In 2008, Tineke Beunders and Nathan Wierink officially launched their company, called “Ontwerpduo” (Dutch for Design duo). Both studied at the Design Academy in Eindhoven and actually launched their company during the first year of their studies. Together, they design everything you can use in and around the home. Mainly lots of domestic items such as lamps, candles, carafes, lighting, and mirrors but also larger objects like the Cubb sofa, for Pode.

“The essence of our Pode sofa is the seat shape. It is ultra-comfortable. The angles, the foam, the design – everything is exactly right. And because it’s pretty basic, it suits every interior.” In our philosophy, the product should do what it’s supposed to do, so you keep the image simple because it doesn’t add to the quality of the product.” We like functionality and a special detail always has a double function. It means you always get two for the price of one: the masculine and the feminine perspective, the more technical approach but also attention for the texture, the colour and the ambience.”



'The essence of  
our Pode sofa is  
the seat shape'





**Sofa** Cubb 2.5-seater **Armchair** Transit Two **Table** Gloss (ø 80 cm) **Occasional table** Gloss (ø 35 cm) **Occasional table** Batch round











# ON THE TABLE, & UNDER IT







Design: Roderick Vos, 2018.

The Tubble table series from Roderick Vos is anything but simple and straightforward. The stunning organic leaf shape has a nice, stylish look. If you have two, they are perfect pushed together. Or beneath each other, if you go for two different heights. And, of course, there are numerous material and colour options. For instance, three beautiful shades of marble quartz: Calacatta, Grigio Carnico and Fior Di Pesco. You can also choose solid oak in all Pode wood stain colours or a lacquered version.

# Coffee table | Tubble



Coffee table	Tubble medium
Colour	Grigio Carnico
Feet	Epoxy Nuit
Coffee table	Tubble medium
Colour	Oak Hazel
Feet	Epoxy Nuit
Coffee table	Tubble small
Colour	Lac Cedar
Feet	Epoxy Nuit



# Table | Fynch

Design: Roderick Vos, 2017.

---

Our Fynch dining-room table is unmistakably Pode. What stands out straight away is the table-top; designer Roderick Vos has opted for a table-top made of solid beech. The table-top rests on a steel frame of laser-cut tubes that slot perfectly into each other. Not forgetting the subtle groove with which the table-top embraces the frame.



Table Fynch 220x100 cm  
Colour Beech Slate  
Frame Epoxy Raven

Design: Kranen/Gille, 2017.

---

An amenable and practical design from Kranen/Gille, known for their iconic Pode Bottle Stool. The recess in the back is a decorative handgrip, which makes Crude easy to move. The optional cushion is available separately and can be created with any of the fabrics in our collection. So you can decide exactly which colour accent you want to add.

## Chair | Crude



Chair Crude  
Colour Beech Charcoal  
Beech Slate



Table Fynch 220x100 cm **Chair** Crude **Rug** Mackay





# Side table & stool | Bottle Stool

Design: Kranen / Gille. 2016.

---

Wine-bottle holder, side table, stool and cheese platter. All brought together in one timeless design. Bottle Stool is really one of a kind. Manufactured in beautiful oak with a semi-transparent stain. That way, the texture and the intricate grain of the wood remain visible in all their glory. It is also portable and handy to use, so you can move it around very easily. Bottle Stool is your best friend in your home.

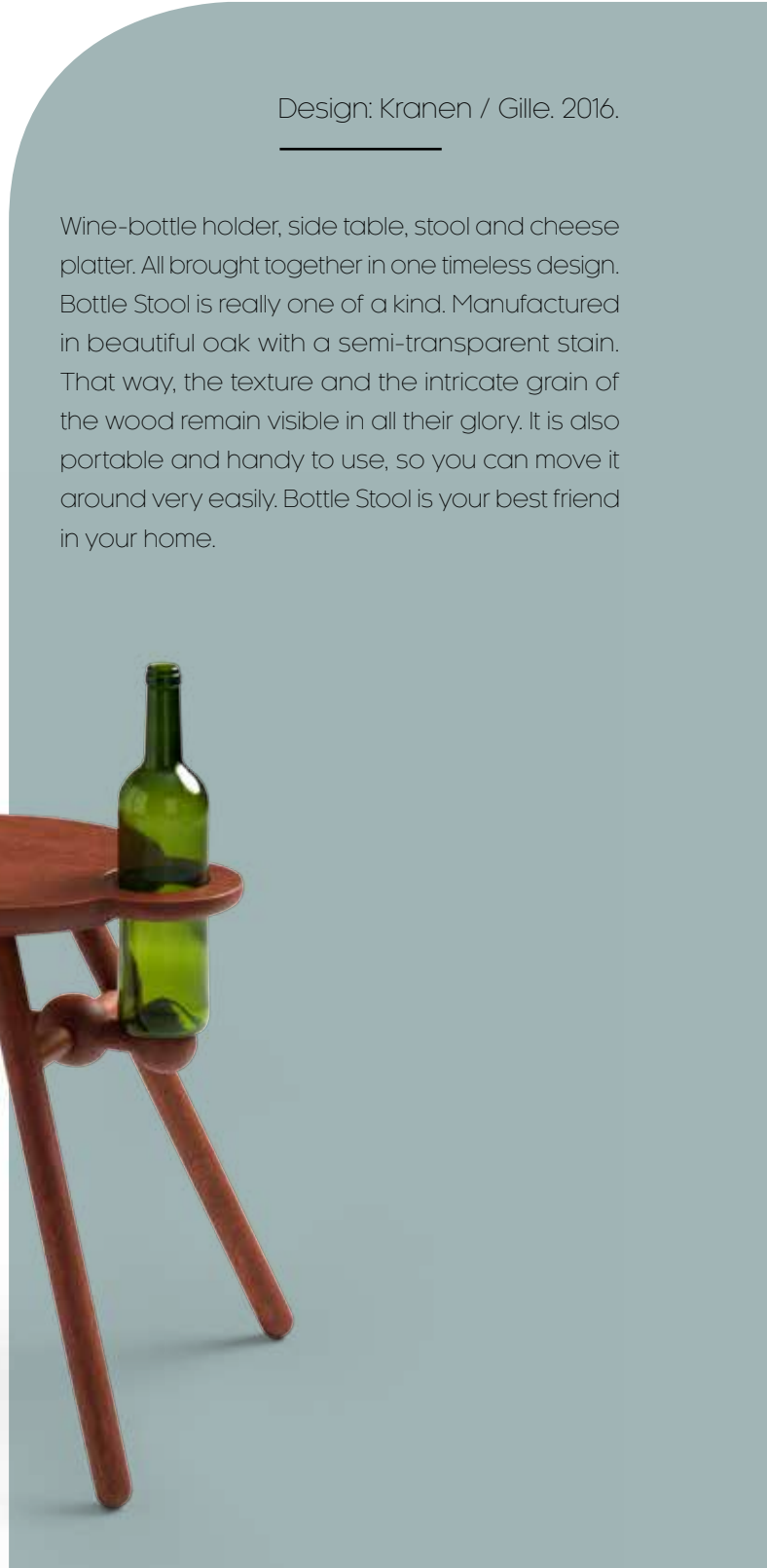

Occasional table   Bottle Stool  
Colour   Brick



'But sometimes  
the inspiration is closer  
to home'

## KRANEN / GILLE

---

Jos Kranen and Johannes Gille know each other from the Design Academy in Eindhoven. They graduated in 2004 in the heyday of the academy, when it was all about progress and innovation. Three years later, they set up the Kranen/Gille design studio in 's-Hertogenbosch. For Pode, they conceived the Bottle Stool.

"We both have a fascination for shapes in nature: a shell, a flower, or a leaf. Very inspiring. But sometimes the inspiration is closer to home. The idea for the Pode

Bottle Stool was born at home. As a lover of a good wine, you quickly discover that you need some kind of coffee table. However, coffee tables are often big and rather static. With the Bottle Stool, we made the table top a little longer so that a bottle of wine can rest exactly on the point of the base. And at the same time, you also have space for two glasses. So it's actually three things in one: a side table, a stool and a wine holder. It's super-functional: it takes up very little space and it's very easy to move around."







**Table** Hux (200x100 cm) **Occasional table** Golden Nugget **Armchair** Sparkle Two **Chair** Chiba

# Chair | Chiba

Design: Pascal Bosetti, 2017.

---

Pascal Bosetti's Chiba for Pode is an excellent dining chair. A very pure design, with an oriental simplicity. And a seat shell of plywood (version "Pure") that perfectly supports your body and adapts to your shape. The upholstered Chiba (version "Padded") offers extra comfort. For beautifully harmonised combinations, you can choose your own combination of materials for the front and back.



Chair Chiba  
Execution 1. Pure Pinegrey  
2. Padded Strand 84  
Frame 1. Tube Epoxy Raven  
2. Skid Epoxy Raven



Design: Roderick Vos, 2017.

---

Roderick Vos: "Your lifestyle doesn't stop with the sofa. The Hux table is "a true friend, while dining". It has an industrial base, and on top of it a wafer-thin ceramic table-top that looks as if it's floating above the frame. Robust and subtle at the same time."

## Table | Hux



Table Hux (200x100 cm)  
Table leaf Glacier White  
Frame Epoxy Khaki

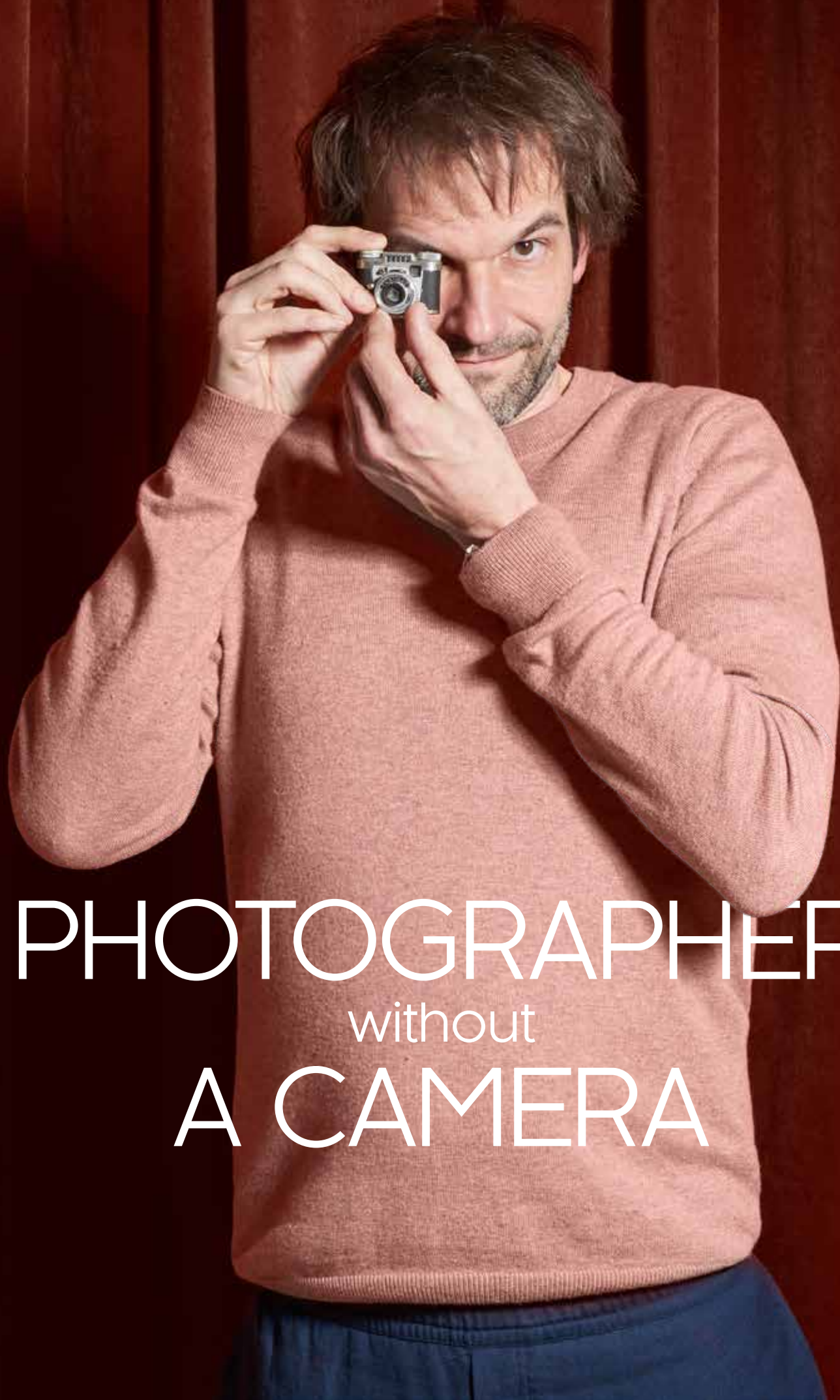

# PHOTOGRAPHER

without

# A CAMERA

## ARJAN BENNING

---

He is one of the Netherlands' most sought-after photographers. Works for major brands like Coca Cola, as well as for newspapers including NRC and De Volkskrant. It was Arjan who made the ambient photos for this Pode magazine. He prefers to describe himself as a storyteller, rather than as a photographer. A conversation about the art of looking.

"I enjoy variety in my work. One day I may be on a set, and the next I may be Editing images. And once per week I give classes at the academy of the arts and tomorrow I will be creating a poster for a cabaret artist. I would not be able to spend a whole week photographing cars or anything like that. There is also the matter of photographic technique and that is something you have to master. Always. I enjoy looking to see what can be derived from a subject. For that, you need a great subject, a friendly team, and a lot of freedom. At Pode, you get all three.

**'I enjoy variety  
in my work'**

**- Arjan Benning**

### **Inspired by Edward Hopper**

The difficult thing about interior photography is that it all looks the same. It's all about looking inwards. There is too little risk-taking. With Pode, we want to stand out, by looking outwards, for example. Pode is aimed at a group of people who do not mind being noticed, so its photography has to be noticed too. Whenever I enter someone's home, their interior tells me a story. Just like the clothes that he or she is wearing. I would also like to tell a story through photography for Pode. I stage settings, but

within them, reality also plays a role. That happens as a matter of course. A model who ties his shoelaces. Not to be photographed, but because they are undone. So I include that too.

The photography for Pode has been inspired by Edward Hopper, the early-20th century realist painter from America. His use of colours is phenomenal, as are his compositions. Composition also plays a major role in interior photography. I usually walk around a bit when a set is being constructed. I choose the position of my camera later on. I mainly look around, and am actually a photographer without a camera.

### **Looking out from the inside**

For this production, we worked with old-fashioned studio walls. This creates a kind of alienation. You wonder what you are looking at: is it genuine, or does it come from a computer? We have also photographed a number of landscapes that you could see out of your window. Everyday landscapes. An interior almost always has something to do with an exterior. That is why I look carefully for the right view, in order to connect the inside and outside with each other. In terms of colour and in terms of atmosphere. That is something few people take account of when designing their home, and it is precisely what Pode is good at - colour and atmosphere.

Pode is a young brand that is still evolving. It is targeted primarily at tomorrow's consumer. It is for young people, and yet it is timeless. It always reminds me of Milan. It has something metropolitan in a friendly way. Very different to other brands. I hope to be able to work for it for a long time yet."





Beanbag Boya Side table Bottle Stool

Design: Roderick Vos, 2016.

Boya is a very stylish member of the Pode lifestyle collection. As with many products from Pode, this beanbag gives you the freedom to create the colour combination that suits you best. Are you going to go for one colour or for your personal two-tone design? Whatever the case, the Fusion leather only becomes more beautiful the more you use it. You can really collapse into this beanbag, which has been cleverly designed so that you can sit or lie down in your Boya and watch the world go by.

# Beanbag | Boya



Beanbag	Boya
Upholstery (from left to right)	1. Fusion Chile
	2. Fusion Raspberry
	3. Fusion Cucumber
	4. Fusion Pesto
	5. Fusion Water
Accent	1. Fusion Cucumber
	2. Fusion Brownie
not available in all international markets	

# Chair | Tokai

Design: Pascal Bosetti. 2017.

---

Even if you're eating a 100-course dinner, with Tokai you can sit comfortably until the very end of the evening. This lovely design by Pascal Bosetti offers excellent comfort for endless enjoyment. Moreover, you have a range of options and materials to create your Tokai exactly according to your personal taste.



Chair Tokai Doppio  
Upholstery Nomad Lead  
Oak Night  
Frame Skid Epoxy Raven





# EVERYTHING ON TABLE

COFFEE- &  
OCCASIONAL TABLE





# Batch

Design: Roderick Vos, 2016.

---

Roderick Vos: "I based the design of these tables on four simple table top shapes, which are Royale, Hexagono, Diablo and Round. The thin table top and the pillar-like foot give this product a quirky, almost 'cartoonesque' character. And despite the industrial appearance, Batch is still a hand-crafted product, made in Holland!"



Roderick Vos, 2019.

---

Roderick Vos is fascinated by materials. He has already created products in leather, fabric, wood, glass and metal for Pode. In Bayan, he used a new material. This modern occasional table is made entirely in ceramic. The deliberate nod to the Art Deco period is another prominent feature. The mix of organic and geometric lines, the glaze colours that blend into each other ... they are all wonderfully recognisable.

## Side table | Bayan



Occasional table	Bayan, Ceramic
Pink	Combination with pink anthracite metallic
Green	Combination with green bronze matt
Red	Combination with red anthracite metallic









# Table series | Tripod

Design: Stephan Veit. 2017.

The name only tells half the story. This series of coffee and occasional-tables does indeed have three legs, each with two kinks so that they merge together at a single point. But Tripod is more than that: the industrial base supports a beautifully crafted triangular table-top with gentle curves. And the combinations of different sizes, heights and finishes are also very handy.



Table Tripod 88x91 cm  
Colour Oak Naturel  
Frame Epoxy Nuit

Table Tripod 70x72 cm  
Colour Lac Eclips  
Frame Epoxy Nuit

Table Tripod 38x39 cm  
Colour Lac Elm  
Frame Lac Elm





# Table | Golden Nugget

Design: Roderick Vos. 2017.

---

Traditional production processes are a source of inspiration for Roderick Vos. After he discovered how to Fold steel, it just wouldn't let him go. He uses the technique on Golden Nugget, a compact side-table (gold-coloured, of course) with raised edges shaped like flower petals. Roderick Vos: 'In the base of Golden Nugget, we've added a special recess for your favourite lifestyle magazines. So that you always have them close at hand.' There is a Golden Nugget for everyone; in gold, or in one of the powder colours of the Batch series (Azurite, Amethyst, Raven, Papyrus and Oxide)



Occasional table Golden Nugget  
Colour Epoxy Sparkling Gold



# THE LIGHT ON YOU

Light is the most important element in an interior. Without light there's no colour, and you can't enjoy the wonderful design of your Pode furniture in the dark. That's why we leave nothing to chance, and why we're introducing four different lamps, each with its own function and character. Light off, spot on for Pom, Uturn, Hood and Pylaz.







# Lamp | Pom

Design: Michael Raasch, 2018.

---

Pom provides you with vibrant light at any moment. If you want to lose yourself in a book in the dark hours, for example. But also if you have a dark corner in your living room, where you wish to create a stylish light source. Pom stands alone on a lovely firm base. You can turn and tilt the shade to direct the light wherever you want it. Only available with euro plug.



# Lamp | Pylaz

Design: Michael Raasch, 2018.

---

Pylaz is a personal butler light. With the flexible frame and the option to turn and tilt the shade, Pylaz makes it easy to provide lighting exactly where you want, whether you're reading or you need additional accent lighting for a visitor. Pylaz is the ideal mood lighting. Only available with euro plug.

# Lamp | Uturn

Design: Michael Raasch, 2018.

---

Has a lamp ever bowed deeply to you? Well, Uturn does. The royal bow in this striking light connects a table-top with a subtle spotlight. Ideal for highlighting a nice souvenir or any other treasured item. Only available with euro plug.

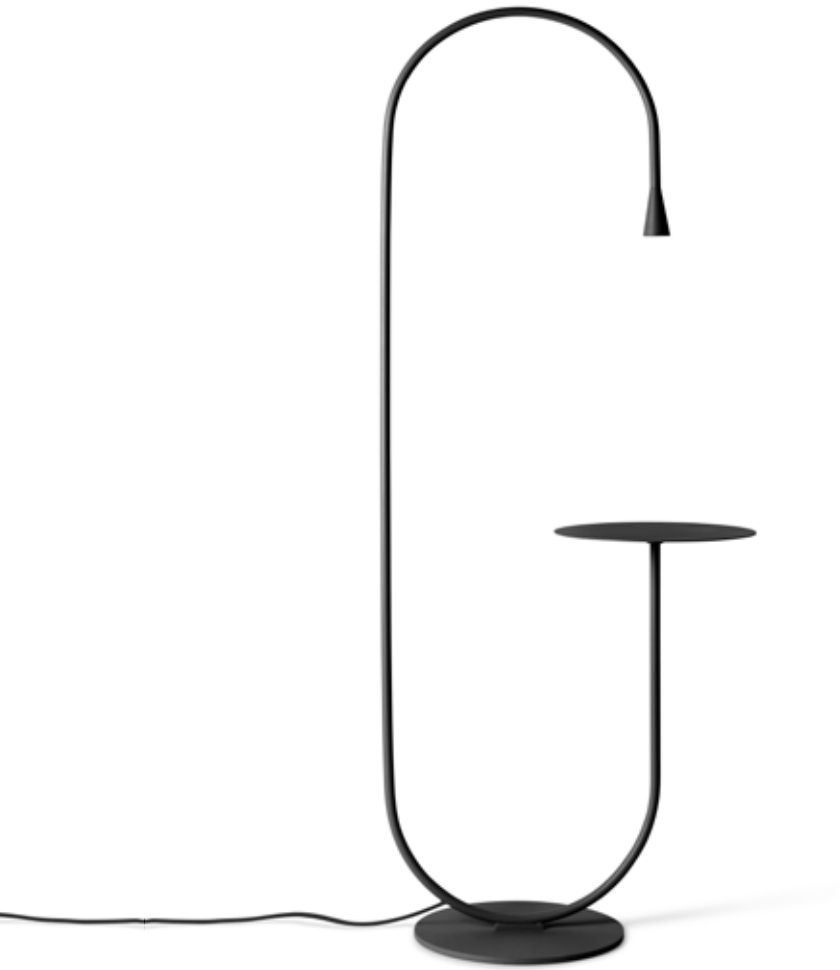

# Lamp | Hood

Design: Michael Raasch, 2018.

---

A lamp like Hood is pure Pöde: you can choose exactly what suits your interior. Because you have a choice of four different shades to place on the frame. These are available individually, so you can change the style of your Hood whenever you wish. A source of light and variation which gives your interior a lovely touch. Only available with euro plug.





'In search of  
the essence'

## Michael Raasch

---

As a designer of furniture, lighting and accessories, German designer Michael Raasch earned his spurs long ago, but he is still fascinated by the design process. You start with nothing, just an idea or a problem. And as the process progresses, something emerges that wasn't there before, something which is shaped purely by the creativity required to resolve the challenges between form, function and technique. That's always exciting.

When designing lighting, you come up against a special challenge, says Raasch. Because you're not just designing the lamp which has to look good as a

'sculpture', but also the light itself. In addition, floor lamps have two functions. Because even when the lamp is switched off, its design still continues to be an element in the interior. It has to enhance the space. That makes designing lighting a specialism in itself.

According to Raasch, all his designs are based on a simple philosophy: his search for the 'essential'. He combines the core function of a product with surprisingly simple solutions and a clear design language, which reappears in different designs. Particularly when designing several products within one collection, he looks for the overarching unity of all the designs.







# ON & UNDER THE SOFA

---

CUSHIONS, THROWS & RUGS

## Abstract

Design: Claire Vos, 2018.

---

Abstract is a versatile Claire Vos cushion with a stylish interaction between different types of upholstery fabrics. The large piece of velvet and the contrasting piping alternate with a delicate fabric made mainly from wool. It is the ultimate in chic.

# Mackay

Design: Claire Vos, 2017.

---

Mackay is never out of style thanks to the timeless pattern based on the classic Scottish Argyle tartan. Bring the Highlands a little closer with this roughly woven Rug in the sizes Medium (180x240 cm) and Large (200x300 cm).





# Cadre

Design: Claire Vos, 2018.

---

A cushion with a bold edge: the Cadre. Designed by Claire Vos, this fits perfectly between the many Pode collection colours and materials. Rounded corners and the front 'panel' finished in a different fabric are features typical of this cushion.



# Dew

Design: Claire Vos, 2016.

---

There is a subtle relief on the front of this Dew cushion that is like Dewdrops resting on the fabric. The asymmetry of the two different types of piping repeats itself when you turn around the cushion and the piping and the back form one surface. It was decided to use a handy square format that matches all the other cushions in the Pode collection.



# Punto

Design: Claire Vos, 2018.

---

Take some wonderful cotton chenille, a beautiful tuft of wool and a huge dose of 70s retro. These are just the right components for Punto; an enchanting rug, designed by Claire Vos. Punto pampers you with an abundance of circles that together form a beautiful composition. The ideal foundation for a living room full of stylish ambience.

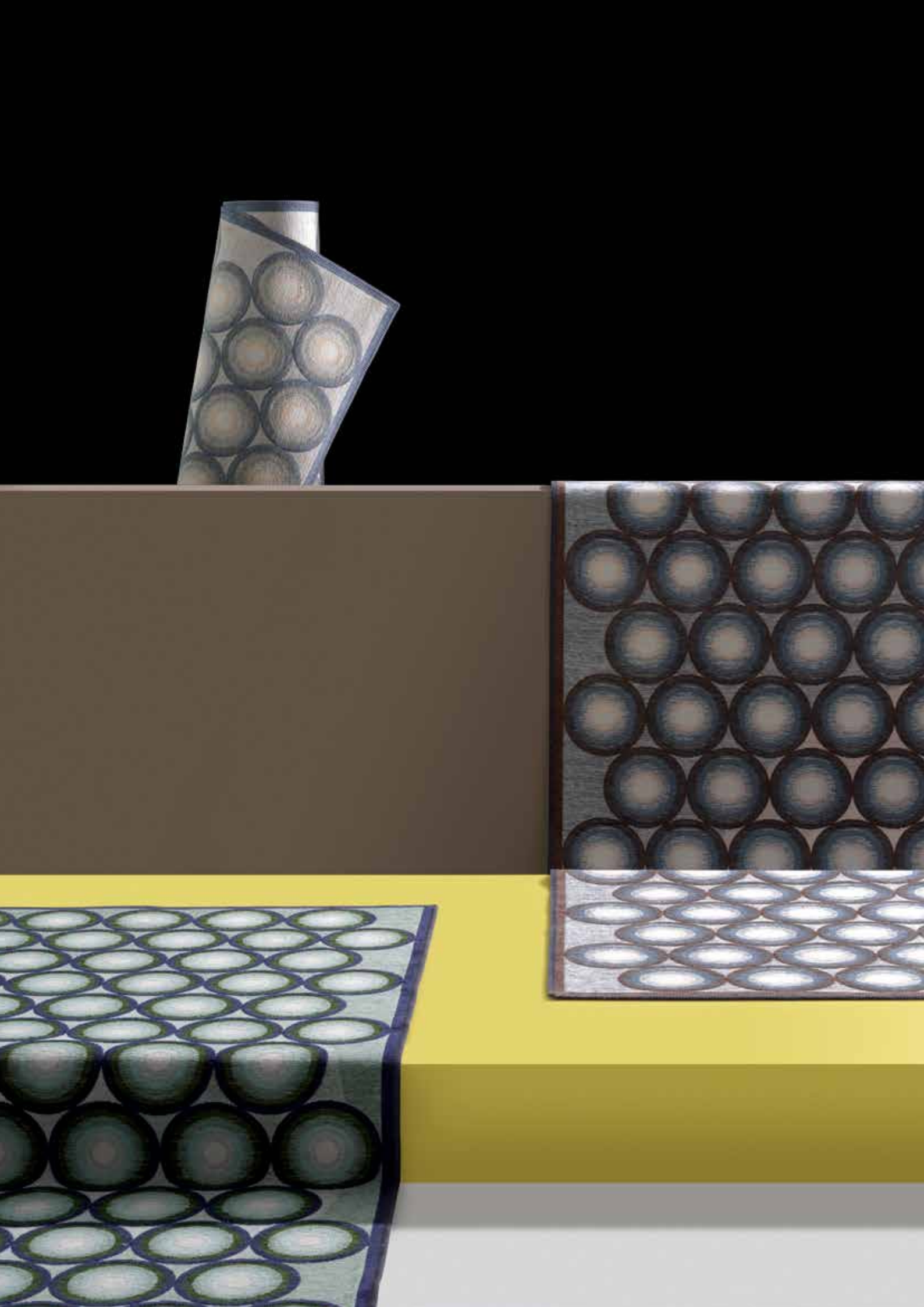



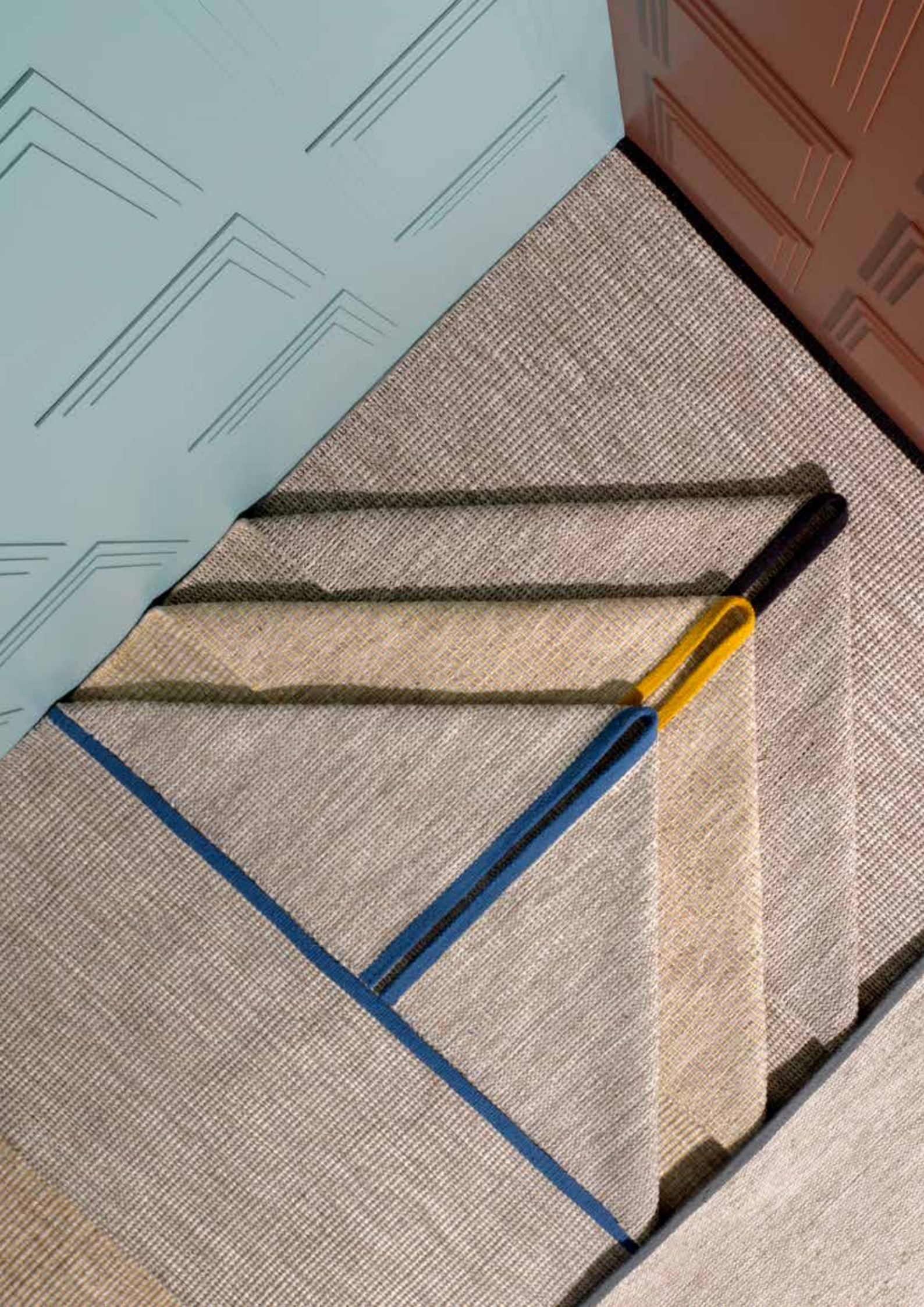



# Haze

Design: Claire Vos, 2016.

---

Thanks to the stitching technique, the plastic mould applied under the fabric creates a subtle detail. It's an old production method that produces a slightly quilted feeling. In combination with the unusual corner pleat, the Haze evokes the soft feeling of morning mist.



# Rye

Design: Maghalie Dooms, 2018.

---

The Rye rug series is Belgian designer Maghalie Dooms' first design for Pode. Each rug is handwoven from a combination of wool and cotton. You can choose from five different colours and four sizes, so you can be certain that there's always a Rye rug that is a perfect match for your style and room.

## Tab (01)

Design: Pode Ontwerpteam. 2015

---

Tab, the decorative cushion with frivolous flat piping on the sides that you use to add rich colour accents to your Pode sofa.

## Dot (02)

Design: Ontwerpduo. 2008

---

Add your own colour accents with the Dot decorative cushions. With playful knots and smart dimensions. Available in almost all the materials in the Pode collection so that they match perfectly with your Pode sofa.

## Dusk & Dawn (03)

Design: Claire Vos, 2016.

---

In the design for Dusk & Dawn, you will find the richness of the geometric patterns from the 1920s. The fabric that Claire Vos designed exclusively for Pode gives the collection its own unique identity: sheen combined with matt, distributed across various surfaces. Used on this cushion, it creates a lovely accent in every interior.

## Puff (04)

Design: Claire Vos, 2017.

---

Puff is the ideal accessory if you need to recharge your battery. A real drape-it-anywhere cushion that you can comfortably nestle in. Nice and big, nice and soft, and the perfect company. Casually finished with generous strips of fabric along the sides for even more grip.



01



02



03



04



# Romboo

Design: Claire Vos, 2017.

---

The Romboo throw blanket adds a warm accent to every interior. Claire Vos selected three attractive colours, so there is a colour tint that suits every living room. The motif is styled and streamlined, but Romboo is also quirky because every corner is slightly different. With a format of 160 by 200 cm, there's more than enough Romboo to lose yourself in.











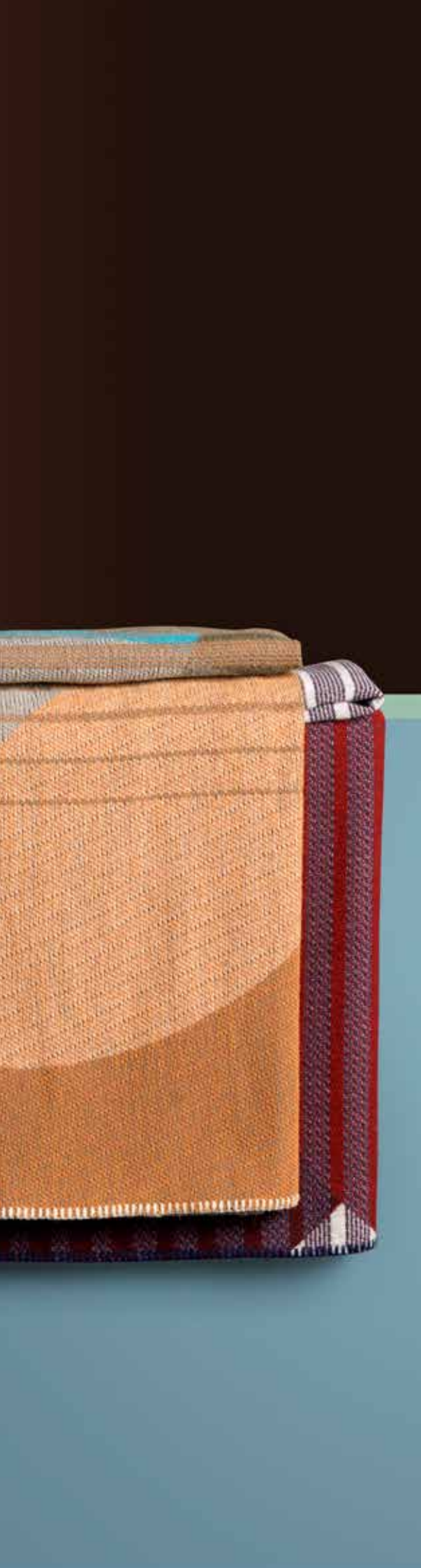

## Swell

Design: Claire Vos, 2016.

---

It's time for glamour, warmth and style. With this Swell series, which is Art Deco inspired, every sofa is transformed into an inviting and attractive place to relax. The jacquard fibres are characterised by strong dynamic lines made up of geometric patterns, such as circles and vertical lines. Combined bright colours or indeed warm deep tones such as mustard, turquoise, and red tints set the tone.

FINDING  
YOUR STYLE  
IS A MATTER  
OF INTUITION







# FABRICS

---

The upholstery that you choose for your furniture will be part of your interior for many years. Pode offers a broad selection of woven materials to cover the sofas and armchairs to your liking. Smooth and coarser fabrics in contemporary colours that perfectly match our leather and lacquer colours. Pode works with high-quality fabrics from renowned suppliers. Well-known brands such as Kvadrat and De Ploeg and various Italian top weavers, selected for you by Pode.

Is your colour not included our standard collection? The fabrics Bolster, Strand, Maple, Divina MD, Tonica, Strand, Hallingdal 65 and Steelcut Trio provide countless extra colours for an additional charge. On request and for an additional charge, we also supply additional quality fabrics from suppliers such as Kvadrat, De Ploeg, Rohi and Alcantara. You can find a complete overview of these fabrics on our website.

## Bolster

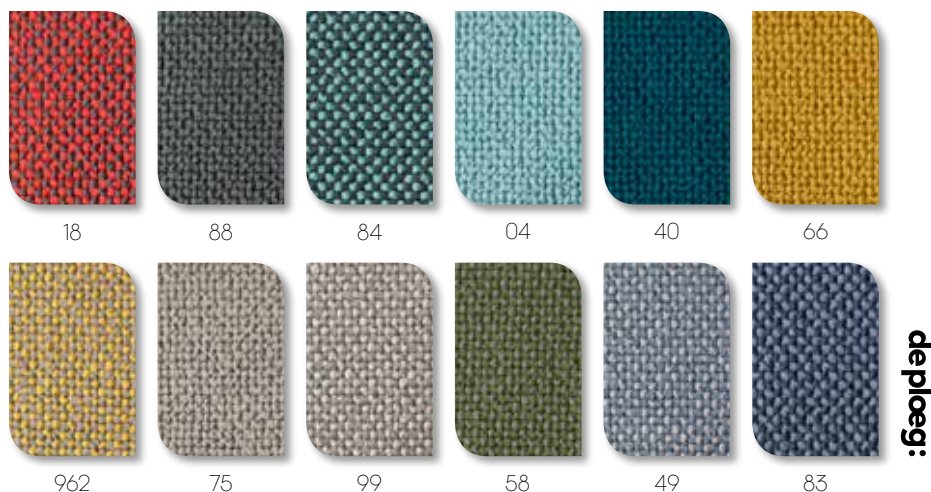

## Divina MD

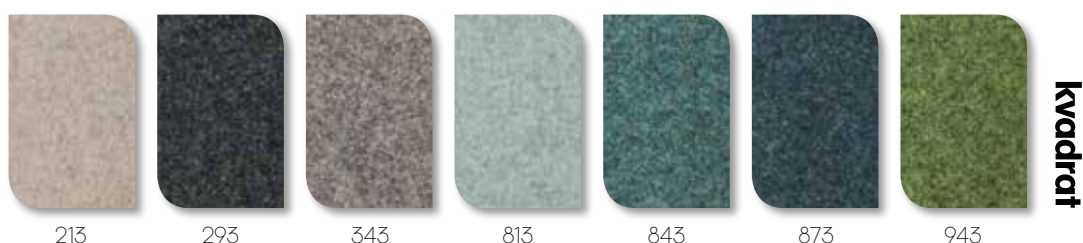



## Fay (not available in all international markets)

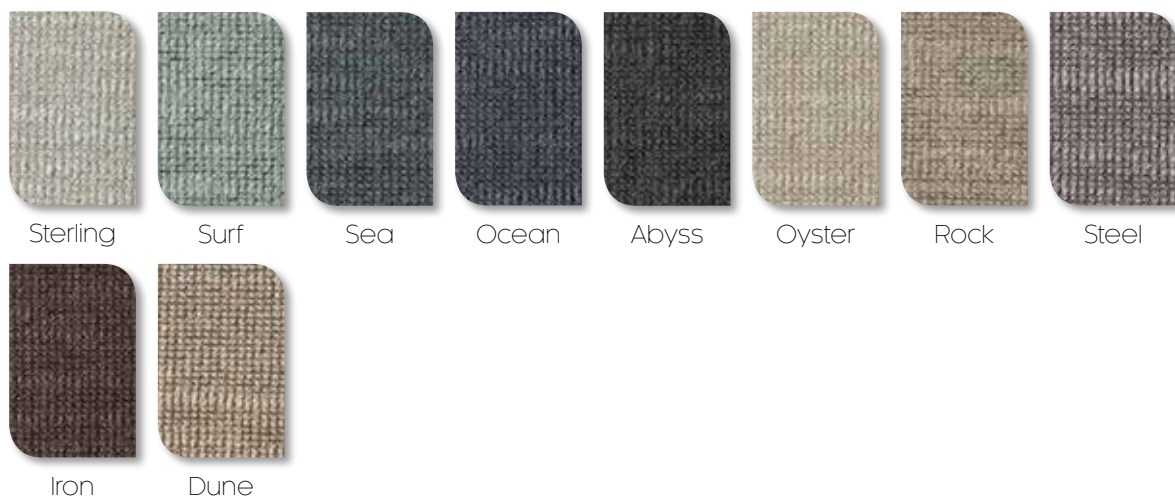

## Fresco (not available in all international markets)



## Hallingdal

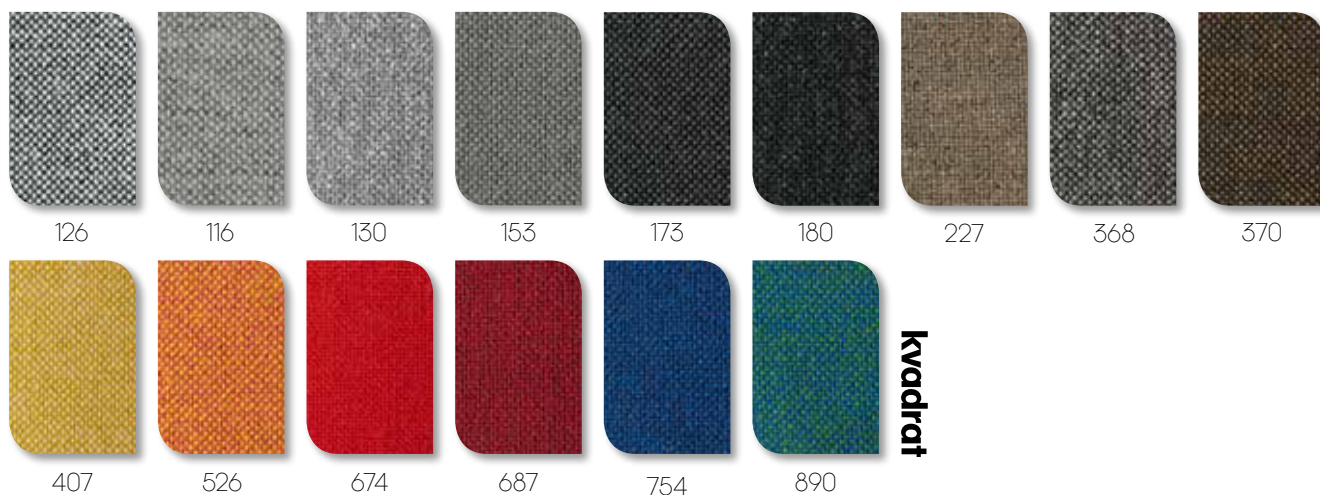

## Maple



## Nomad (not available in all international markets)



## Ruvido (not available in all international markets)



## Strand

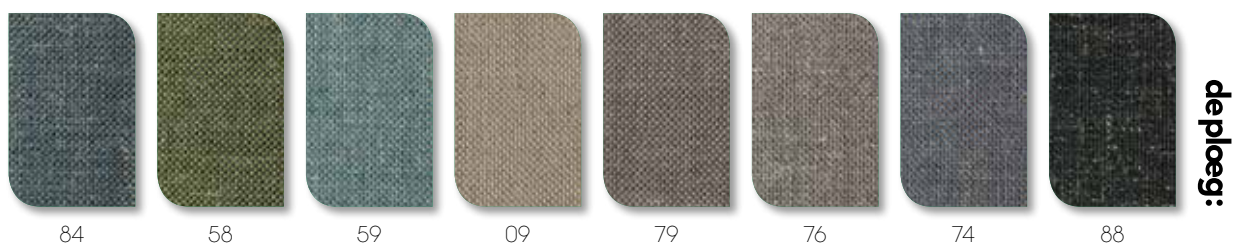



## Steelcut Trio

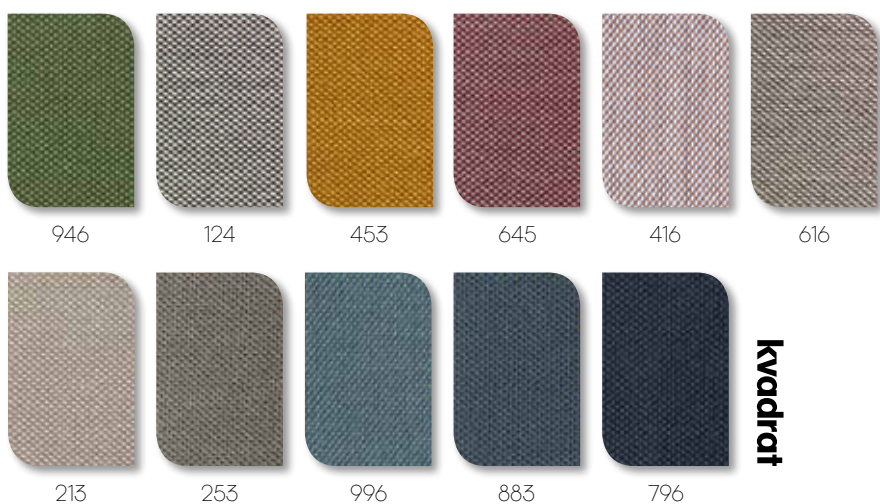

## Tonica

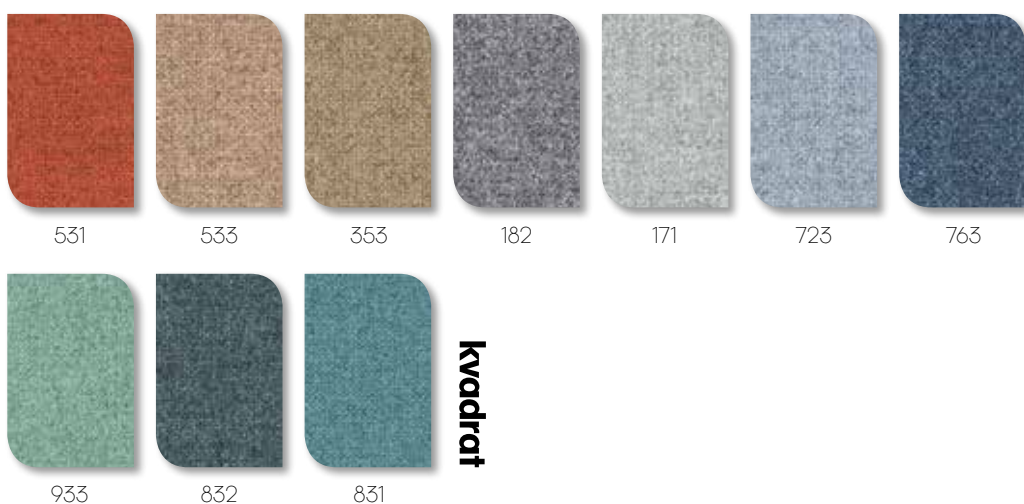

## Tweed (not available in all international markets)



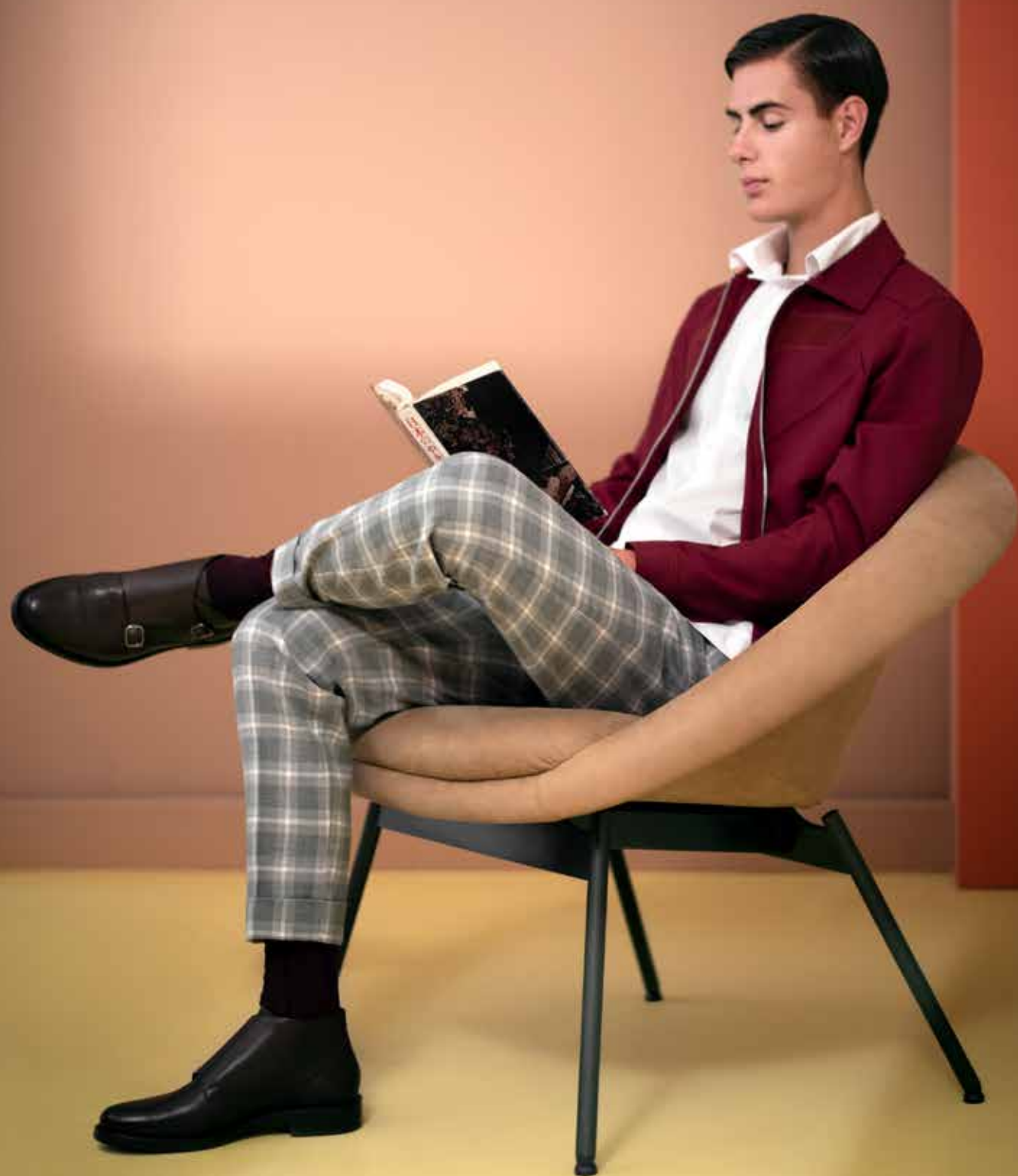

# LEATHER

---

Leather is wonderful upholstery material. At Pode, you can choose between three high-quality basic variants of cowhide, which we then use to cover your favourite item of Pode furniture in the colour of your choice:

- Fusion leather is available in no less than 18 beautiful colours. The thickness and finishing of the material gives it a unique character and a high user value, even when you use it intensively.
- Perle is a soft, grained, brilliantly coloured leather, which even so is suitable for daily use. To achieve this result, during the finishing process, the hides undergo a special process that gives the leather a strong and somewhat matt top layer.
- The lightly sanded Neron leather gives your Pode furniture a pure and natural look. It is real natural leather, so it becomes part of your life and grows more beautiful the more you use it. Neron is available in seven lovely colours.

## Fusion

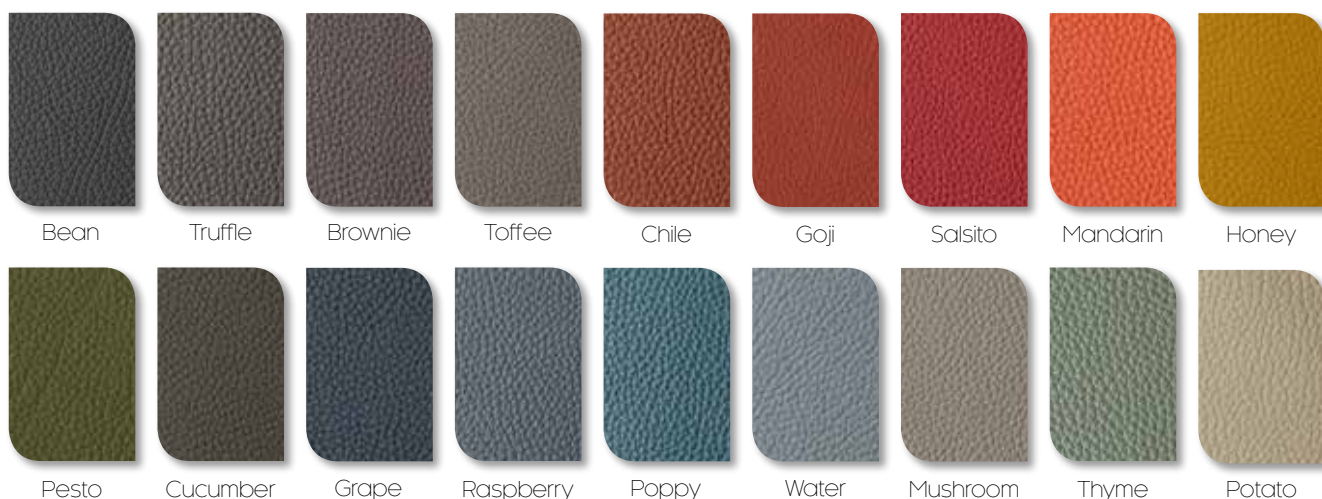

## Perle



## Neron





# OTHER MATERIALS

---

The perfect finishing is created when all colours in a collection are coordinated with each other. At Pode, we focus on all the finer details: Lacquer colours, epoxy (varnish), decorative seams and wood colours blend in with the upholstery or create a spicy contrast. Choose what suits you best!

## Lac & stitch



## Epoxy



## Batch



## Bottle Stool



## Wood Oak



## Wood Beech



## Ceramic



## Tubble



# DIMENSIONS





# Sofa programmes

## Ziggy

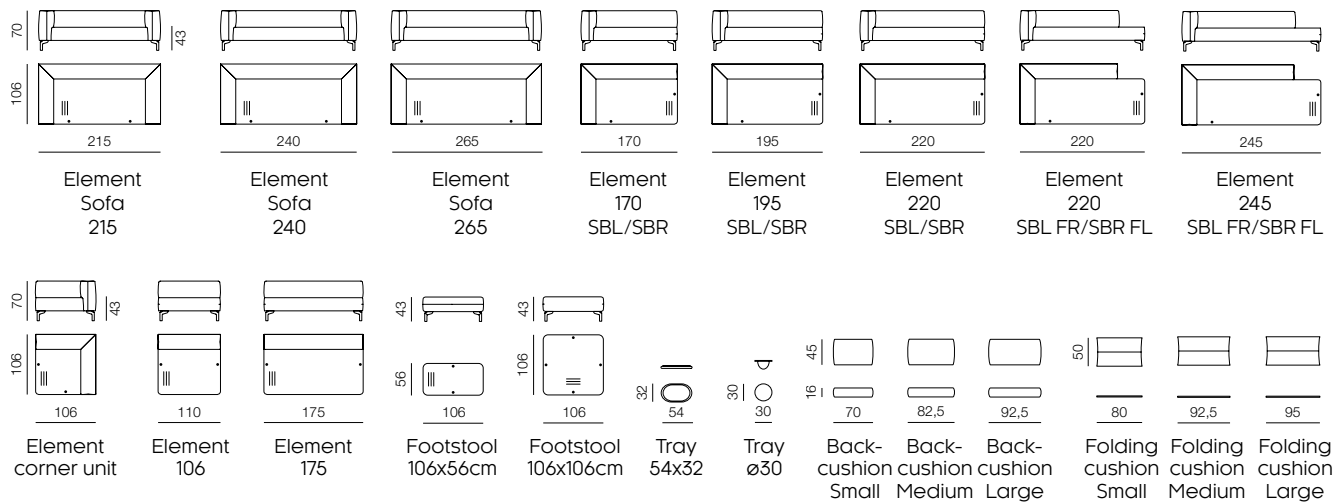

## Examples:

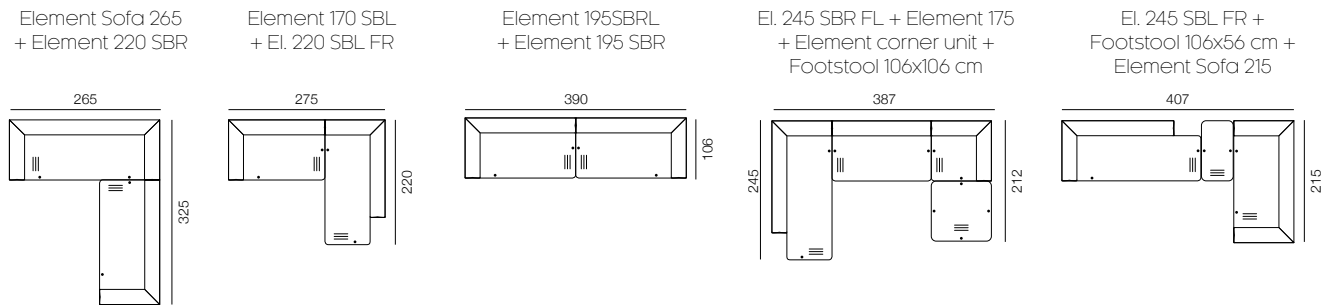

## Melloo

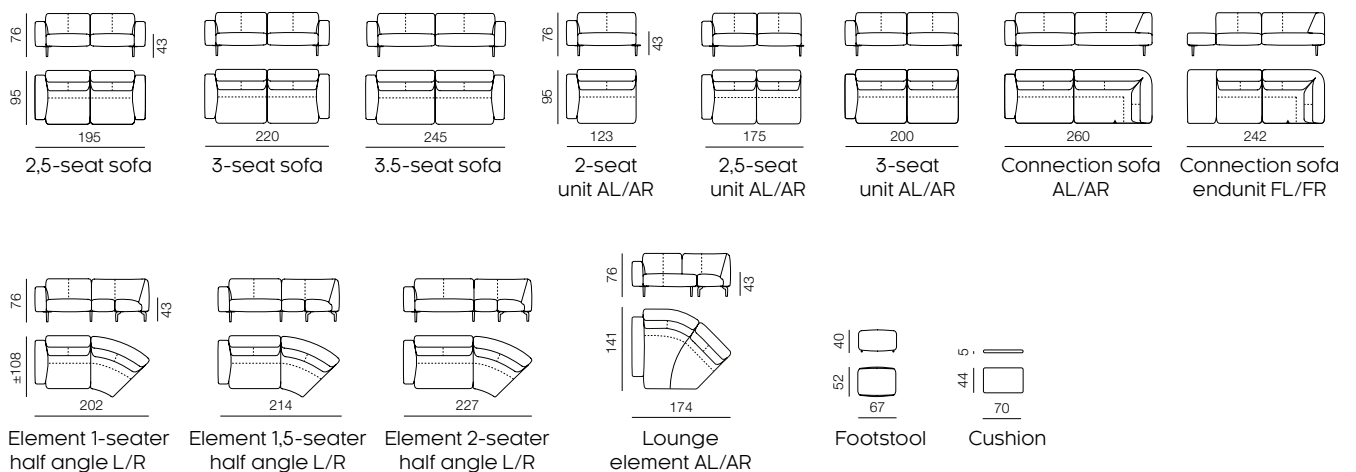

## Examples:

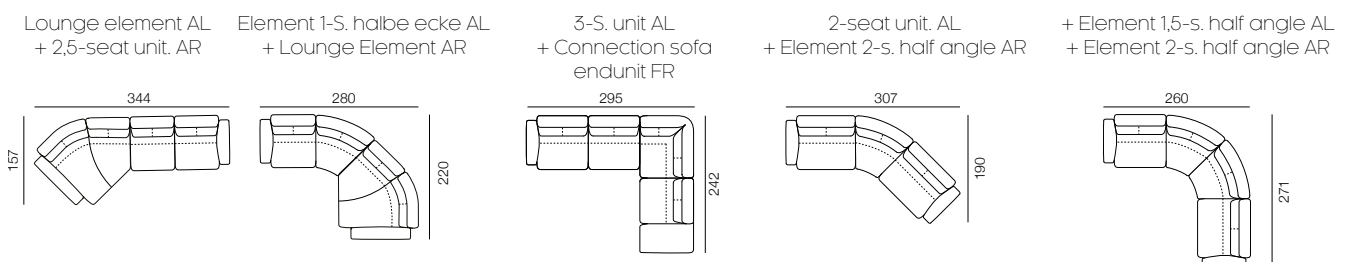

## Fold

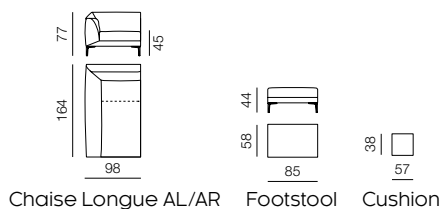
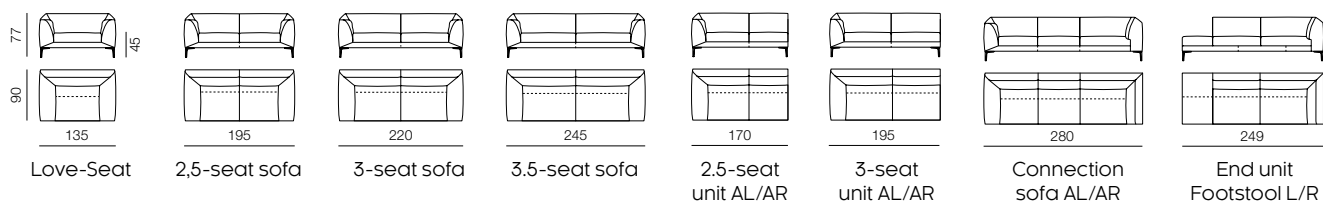

## Examples:

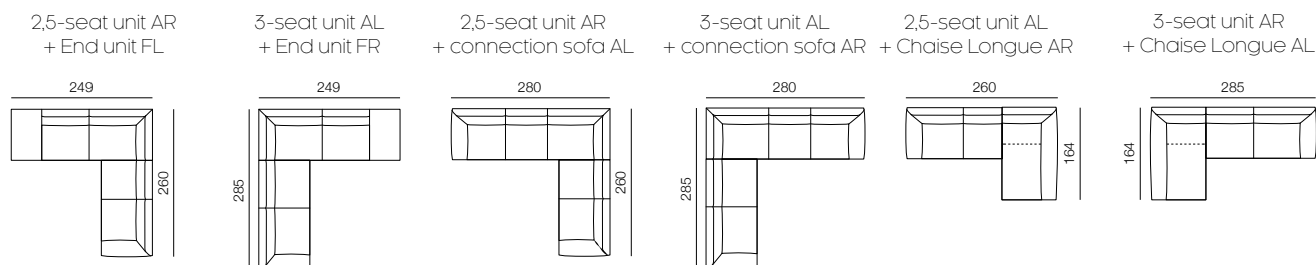

## Insert

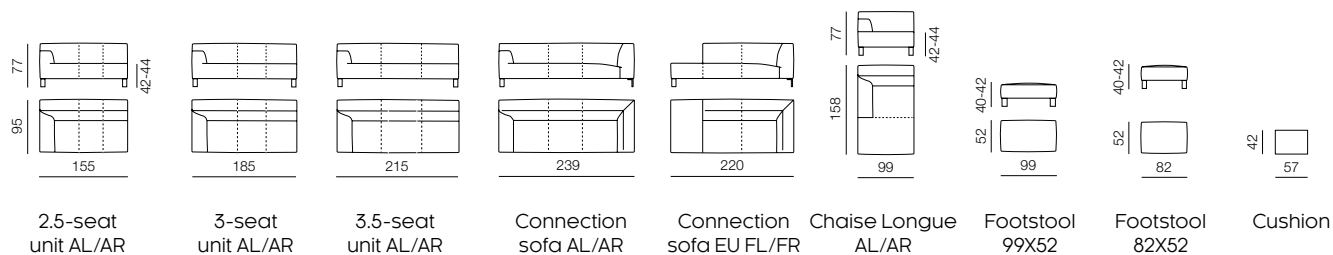

## Examples:

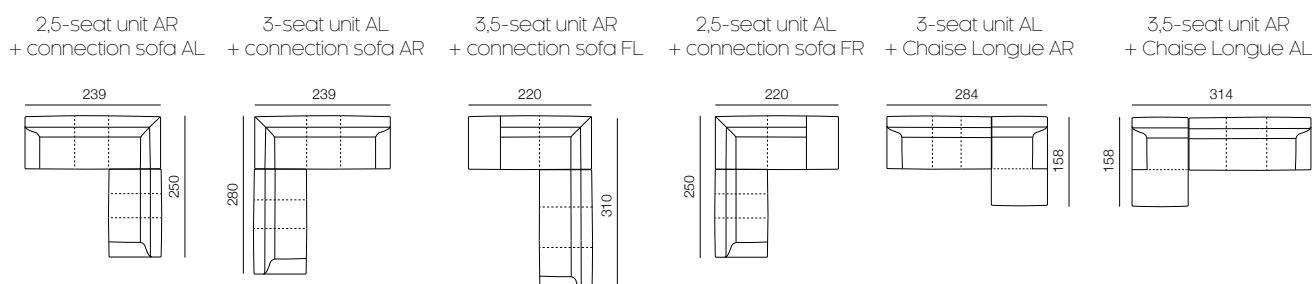



## Sofas

### Edit

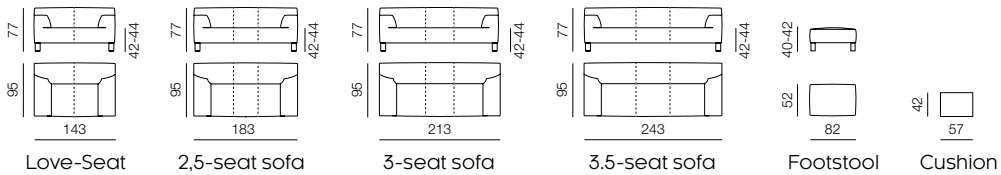

## Swipe

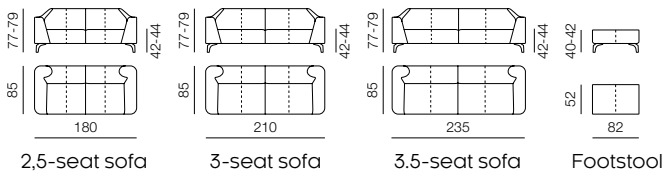

## Cubb

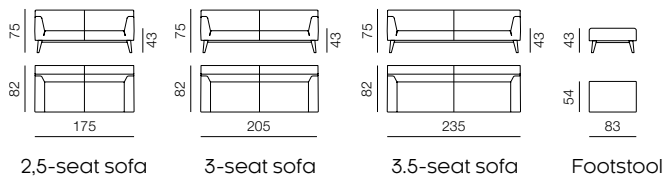





# Dining-room table

## Fynch

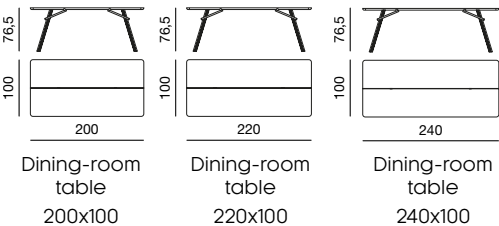

## Hux

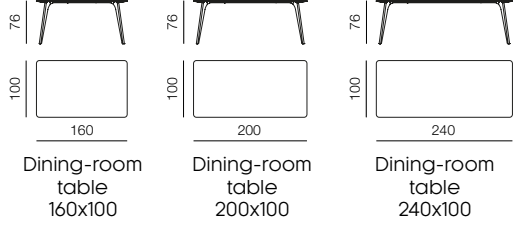

# Dining-room chair

## Chiba

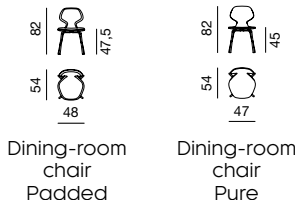

## Crude

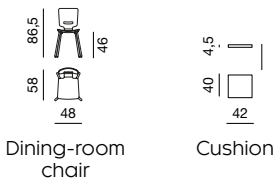

## Tokai

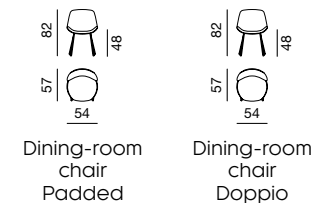

# Armchairs & beanbag

## Boya

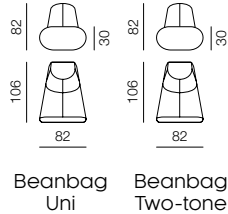

## Nihan

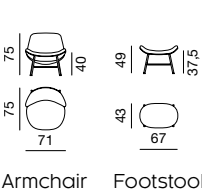

## Sparkle

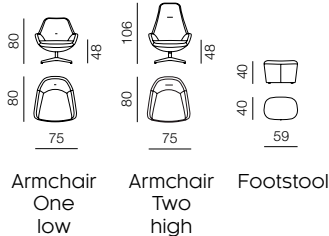

## Spot

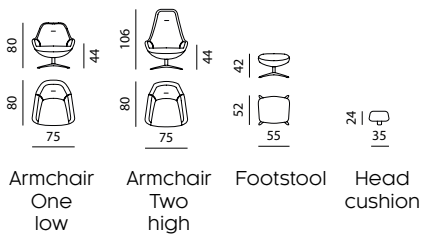

## Tibia

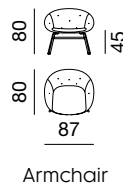

## Transit

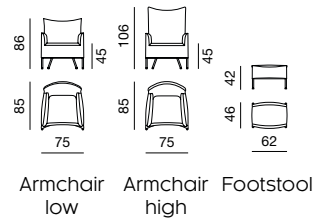

# Coffee tables & side tables

## Batch

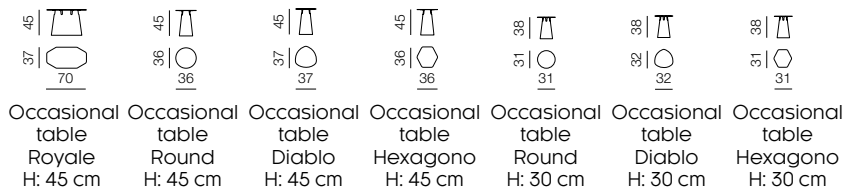

## Bayan

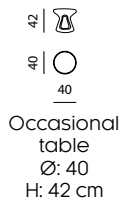

## Bottle Stool



## Golden Nugget

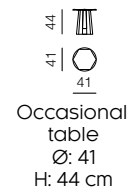

## Skitch

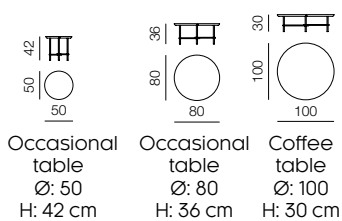

## Tripod

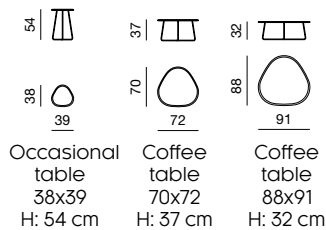

## Tubble

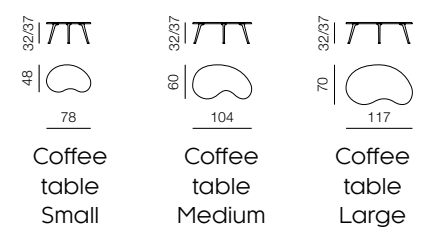

# Rugs

## Mackay

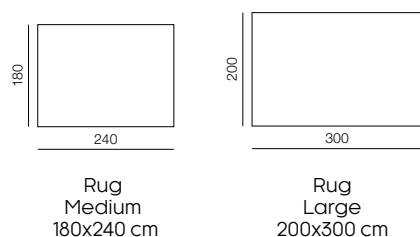

## Punto

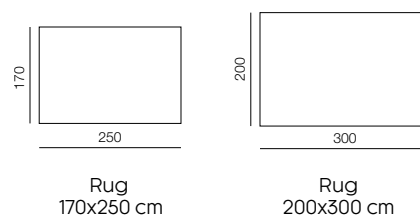









## Rye

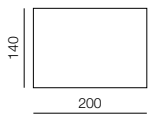

Teppich  
140x200cm

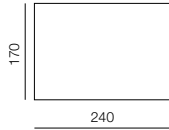

Teppich  
170x240cm

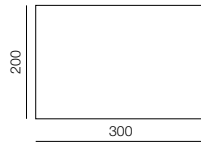

Teppich  
200x300cm

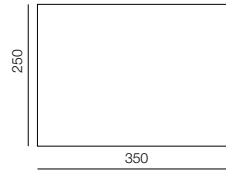

Teppich  
250x350cm

## Accessoires (lightning only available with euro plug)

### Uturn

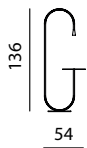

Lamp

### Pom

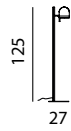

Lamp

### Hood



Lamp

### Pylaz

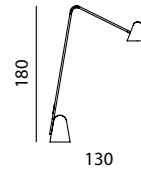

Lamp

### Abstract



Cushion  
60x28 cm

### Cadre



Cushion  
60x50 cm

### Dew



Cushion  
42x42 cm

### Dot



Cushion  
Small  
50x33 cm



Cushion  
Medium  
67x25 cm

### Dusk & Dawn



Cushion  
73x27 cm

### Haze



Cushion  
48x30 cm



Cushion  
50x45 cm



Cushion  
76x30 cm

### Puff

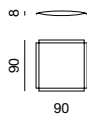

Cushion  
90x90 cm

### Tab



Cushion  
60x40 cm



Cushion  
60x50 cm



Cushion  
80x30 cm

### Romboo

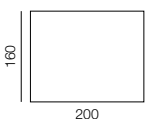

Throw  
160x200 cm

### Swell

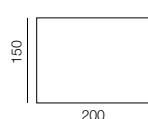

Throw  
150x200 cm







# Service & guarantee

## Service and guarantee

We deliver our products in good condition. Needless to say, our follow-up service extends much further. A top brand such as Pode naturally has an outstanding service and guarantee scheme.

## What do we do?

Pode delivers perfect products and we want to keep it that way. If, despite the great care that we take, anything should go wrong in the first 2 years, a 100% guarantee

scheme applies. Visit [www.pode.eu](http://www.pode.eu). The full guarantee scheme is displayed there.

## What can you do yourself?

All upholstery, both fabric and leather, comes from top suppliers. And everything has been extensively tested for strength and colour fastness. So it lasts a really long time. But you too can contribute to this by taking good care of the upholstery.

You can find some handy tips on [www.pode.eu](http://www.pode.eu).

---

# Colophon

This magazine is a Pode publication  
(collection 2019)

**Editor:** Hans Filippini | Claire Vos

**Art Direction:** Studio Roderick Vos

**Photos:** Arjan Benning Film & Photography | Styling en productie Kamer 465, Anya van de Wetering & Marie-Claire Lambalk | Judith Rasenberg | Styling-assistenten Annelies Stob & Rachel Louman | Assistent fotografie Tim Posthumus Meyjes | Visagie Joyce Clerckx **Art Direction photography:** Studio Roderick Vos | Set assistent Julia Jacobs | Beeld- bewerking Arjan Benning & Polina Gladkova **Product photography:** Zebra Fotostudio's | Peer Coopmans **Portrait photography:** Lisa Klappe | Hugo Thomassen **Text:** Ben Salden | Antal Németh | Bubo Bubo / Ben Veld **Design:** Peer Coopmans | Claire Vos

**With thanks:** Kvadrat | Vij5 | Raymakers | Kranen / Gille | Tuttobene Sales Agency | Cor Unum | Form Focus | Zara | Bijenkorf | Hudson's Bay | COS | Vliegerpapier | Repetto | Chloe | NLXL design behang | [www.echtemensen.com](http://www.echtemensen.com) | **Clothing model Bente:** Cover [www.uniqlo.nl](http://www.uniqlo.nl) cover [www.stevemadden.com](http://www.stevemadden.com) | Pag 64 / 66 [www.uniqlo.nl](http://www.uniqlo.nl) | Pag 64 / 66 [www.carolinebiss.com](http://www.carolinebiss.com) | **Clothing model Pybe:** Pag 66 [www.shoptoms.nl](http://www.shoptoms.nl) | Pag 120 [www.arket.com](http://www.arket.com) | **Clothing model Sarah:** Pag

27 [www.filippak.com](http://www.filippak.com) | **Clothing model Lola:** Pag 10 [www.twinsset.com](http://www.twinsset.com) | Pag 10 [www.drykorn.com](http://www.drykorn.com) | Pag 115 [www.japaneseantiquestore.com](http://www.japaneseantiquestore.com) | Pag 7 [www.tichelaar.nl](http://www.tichelaar.nl) | [www.stories.com](http://www.stories.com) **Styling accessoires:** cover Etagiere houten [www.japaneseantiquestore.com](http://www.japaneseantiquestore.com) | Pag 5/ cover Origami kraanvogels [www.japansewinkeltje.nl](http://www.japansewinkeltje.nl) | Pag 4 The Lucky Cat [www.donkeyproducts.com](http://www.donkeyproducts.com) | Pag 10 schaaltes en mobile sculptures [www.timeandstyle.nl](http://www.timeandstyle.nl) | Pag 10 Art Deco potje [www.antiquetileshop.nl](http://www.antiquetileshop.nl) | Pag 19 Japanse poppen [www.timeandstyle.nl](http://www.timeandstyle.nl) | Pag 19 Design auto [www.frozenfountain.nl](http://www.frozenfountain.nl) | Pag 21 koptelefoon [www.frozenfountain.nl](http://www.frozenfountain.nl) | Pag 21 Bril [www.aceandate.com](http://www.aceandate.com) | Pag 21 vaas [www.antiquetileshop.nl](http://www.antiquetileshop.nl) | Pag 66 lak japanse box [www.japaneseantiquestore.com](http://www.japaneseantiquestore.com) | Pag 66 Japanse accessoires [www.timeandstyle.nl](http://www.timeandstyle.nl) | Pag 66 Japanse accessoires [www.antiquetileshop.nl](http://www.antiquetileshop.nl) | Pag 145 Japanse poppen [www.timeandstyle.nl](http://www.timeandstyle.nl)

**Models:** Jaap | Hugo | Simba | Mathijs te Kieft | William van Esveld | Micky van Esveld | Wouter Wieringa | Julia Jacobs | Quinn Sanders | Anousjka Röben | Marthe Vos | Wiebe Vos | Kilian Vos | Alicia Anais Fuentes | Polina Gladkova | Jeffrey de Waal | Harold Lunenburg | Iris Gyselink | Shaheen Hameedah Butt | Bente van Wamel | Pybe van der Wal | Lola Willems | Sarah Neutkens | Yuna Staps | Steven Peelaerts

Kazernestraat 15 • 5928 NL Venlo • The Netherlands  
Tel. +31 (0)77-3877222 (Mon to Fri from 8.30 a.m. to 5 p.m.)  
Email: [info@pode.eu](mailto:info@pode.eu)

[www.pode.eu](http://www.pode.eu)





pode

For a complete dealer overview go to  
[www.pode.eu](http://www.pode.eu)